

RESERVOIR SHOCKS

JEEP JK

RSO SUSPENSION

Components:

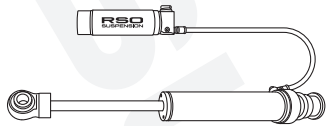

Front Shocks
Qty 2

Hardware:

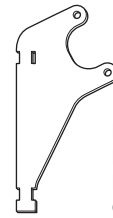

Remote
Reservoir
Brackets
Qty 2



Hose Clamps
Qty 4



Thread Cutting
Screws
Qty 4

Tools Required:

16 MM SOCKET/WRENCH
16 MM OPEN-END WRENCH
18 MM SOCKET/WRENCH
18 MM OPEN-END WRENCH
9/16" SOCKET/WRENCH
TORQUE WRENCH
SOCKET WRENCH EXTENSION
POWER DRILL
11/32" DRILL BIT
FLAT HEAD SCREWDRIVER
JACK/JACK STANDS

Safety Warning:

Aftermarket suspension systems or components may cause your vehicle to handle differently than it would with factory components. Please use caution to prevent loss of control or vehicle rollover during quick sharp turns and other sudden maneuvers. Thoroughly inspect vehicle suspension and components before and after every off-road use. RSO Suspension recommends the use of your Factory Service Manual for disassembly and assembly of factory and related components. Tighten all bolts and hardware to factory torque specifications unless otherwise specified in this instruction.

Post Installation Notes:

Upon completion of installation and within 50 miles of driving, it is necessary to check and ensure all hardware is properly torqued to factory specifications as noted in the factory service manual or as specified in this instruction.

RESERVOIR SHOCKS

JEEP JK

RSO SUSPENSION

INSTRUCTIONS

1. Remove Original Front Shocks

Begin by raising and supporting the vehicle using a hydraulic jack or a vehicle lift. Support the axle using jack stands or axle hoists. Remove the wheels and tires for easier access to the shock mounting hardware.

Using a 16 MM Wrench, remove the upper mounting nut securing the shock on the top of the shock tower. Some models may have interference caused by the battery box. In this case, simply break away a small section of the thin plastic to gain access.

Remove the lower shock mounting hardware using an 18 MM Socket/Wrench and 18 MM Open-End Wrench. Retain this hardware to be used for installation. Once this hardware is removed you may remove the original shock from the vehicle.

2. Install Front Reservoir Shocks

Remove the mounting nut, top retainer and top rubber grommet from the shock assembly. Insert the threaded stud of the shock through the hole in the top of the shock tower. While holding the shock in place, install the top rubber grommet and top retainer before threading on the mounting nut (2a). Tighten the mounting nut until the grommets bulge slightly using an 18 MM Open-End Wrench. Factory torque specification is 20 ft lbs.

Position the lower end of the shock to where it lines up with lower shock mount. Attach the shock to the lower shock mount using original hardware (2b). Tighten using an 18MM Socket/Wrench and 18 MM Open-End Wrench. Factory torque specification is 56 ft lbs.

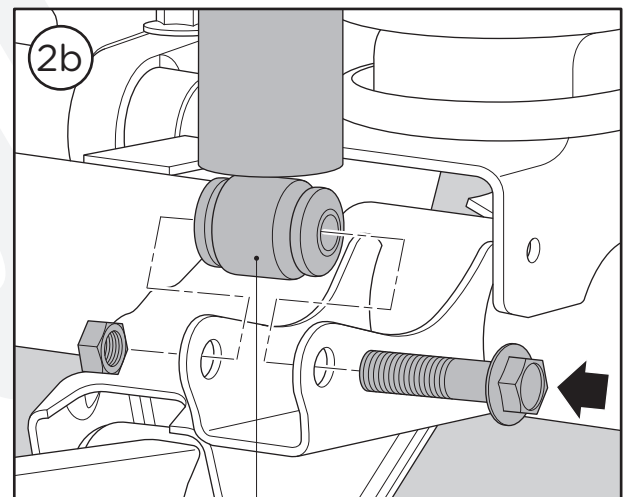
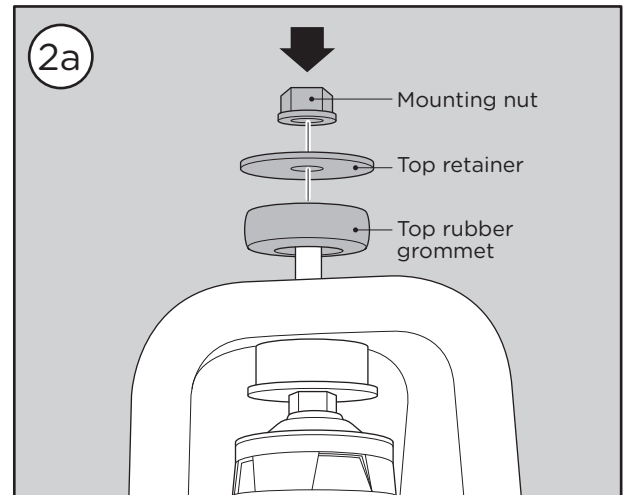

Lower end
of shock

RESERVOIR SHOCKS

JEEP JK

RSO SUSPENSION

3. Mount Remote Reservoir

Next you will need to mount your remote shock reservoir. If using provided Remote Reservoir Brackets, locate the circular hole in the vehicle frame on the front side of the front upper coil spring mount.

Place the Remote Reservoir Bracket against the frame with the curved section around the circular hole in the vehicle frame (3a). The arm of the bracket will extend towards the rear of the vehicle. Hold the remote reservoir in place against the bracket and determine desired bracket placement. Be sure to check for suspension and tire clearance before you permanently mount the reservoir.

Once desired bracket location has been determined, mark drilling locations for two mounting holes to attach the bracket to the vehicle frame (3b).

Drill using an 11/32" drill bit (3c) and fasten with provided Thread Cutting Screws using a 9/16" Socket/Wrench (3d).

Attach the remote shock reservoir to the Remote Reservoir Bracket using provided hose clamps (3e). One of the hose clamps will need to be threaded through the slot on the Remote Reservoir Bracket. Tighten using a Flat Head Screwdriver (3f).

