

# TIE ROD/DRAW LINK INSTALLATION

SKU# 170107-442200

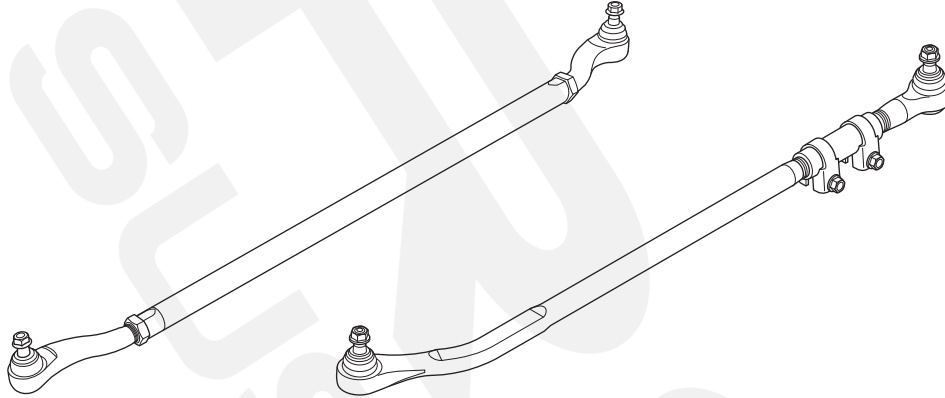

## COMPONENTS



Qty: 1  
HD Tie Rod

Qty: 1  
Drag Link

### Steering Stabilizer Bracket Package

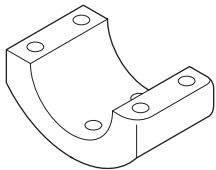
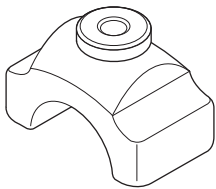

Qty: 1  
Steering Stabilizer  
Bracket

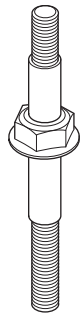

Qty: 1  
Steering  
Stabilizer  
Relocation  
Mounting Stud

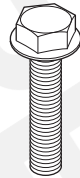

Qty: 1  
1/2" Hex  
Head Bolt

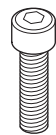

Qty: 4  
Socket Head  
Cap Screw



Qty: 1  
7/16" Washer



Qty: 2  
1/2" Washer

## TOOLS REQUIRED



2.5mm  
Allen Wrench

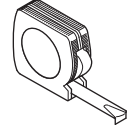

Tape  
Measure

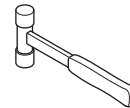

Hammer

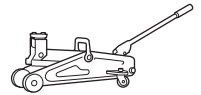

Jack



Jack Stands

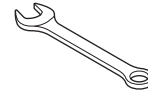

1/2" Open  
End Wrench

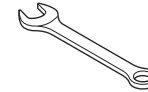

7/16" Open  
End Wrench

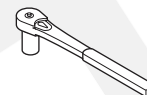

21mm Socket

## INSTALLATION NOTES

NOTE: The factory steering stabilizer clamp will not fit on your new HD tie rod. The supplied 1-5/8" steering stabilizer clamp will be required.

Remove all contents from the package and inspect for any damage. Also, verify that all components listed above are included before you begin installation. If anything is missing or damaged please contact us at [customerservice@raptorseries.com](mailto:customerservice@raptorseries.com)

Read through entire installation manual and installation drawings to ensure that you understand all of the components before proceeding with installation.

# TIE ROD INSTALLATION

170107-443900

# RSO SUSPENSION

1. Chock your rear tires and then raise the front tires off the ground using a jack. Remove the front tires.

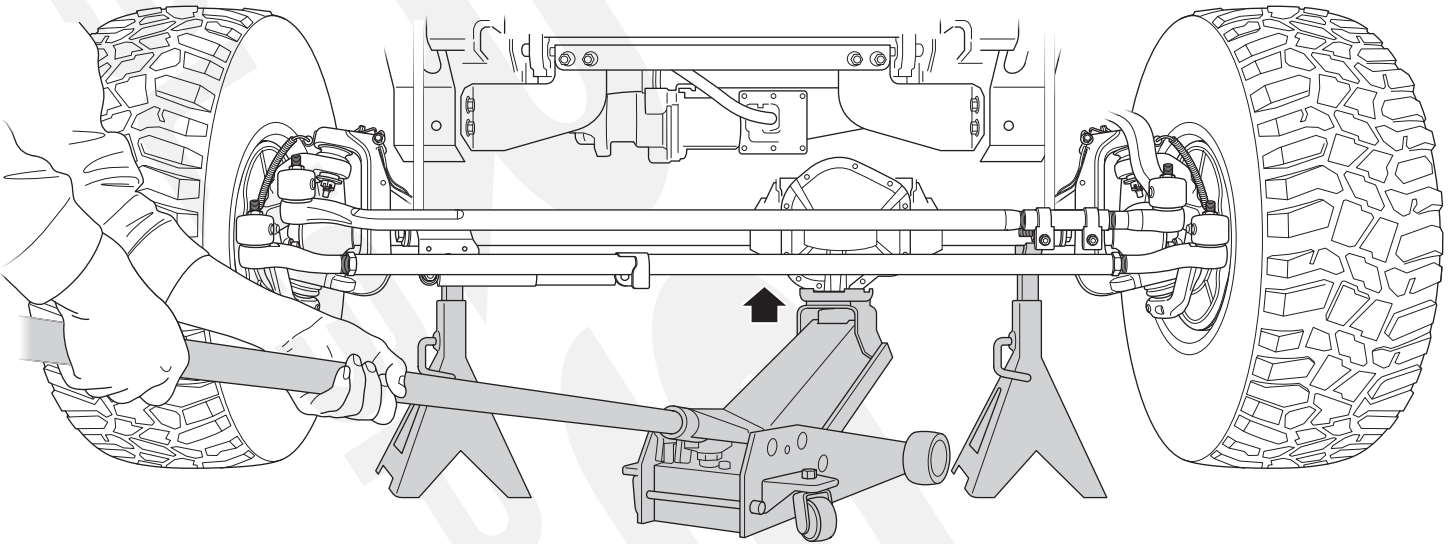

2. Remove Steering Stabilizer by first loosening the Nut using a 21MM socket (2a) and then removing the Nut (2b). Once Nut is removed, wiggle the Steering Stabilizer back and forth and pull from housing. Once the Steering Stabilizer is removed from housing, swing the Steering Stabilizer downward.

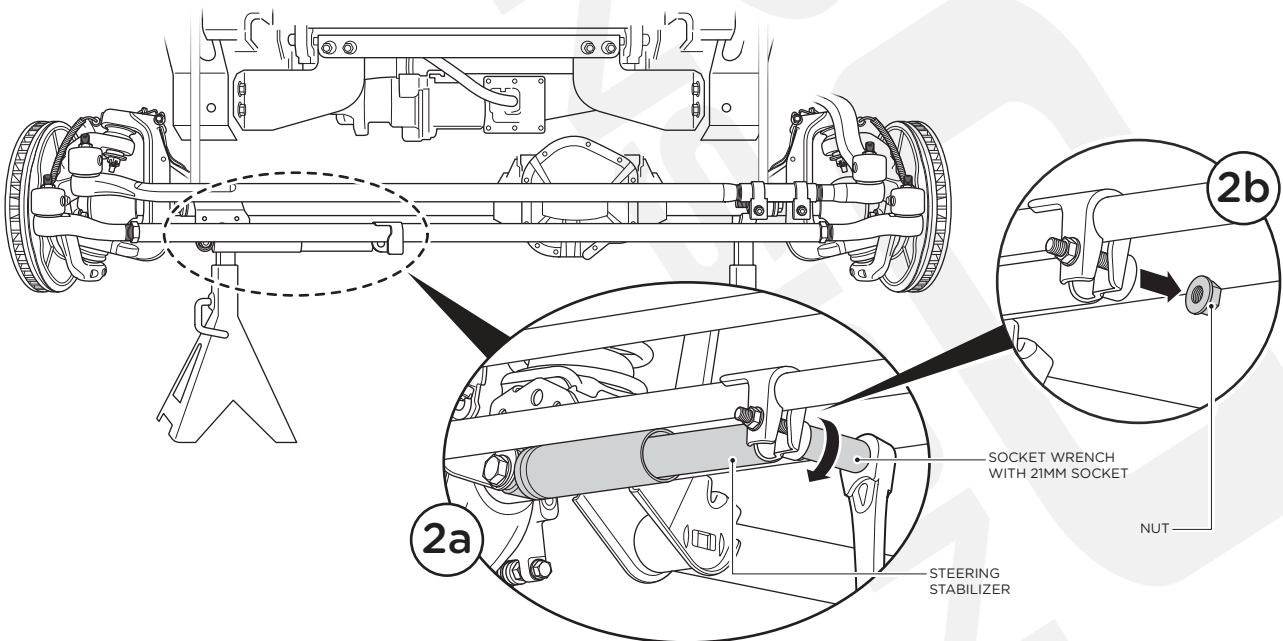

# TIE ROD INSTALLATION

170107-443900

# RSO SUSPENSION

- 3.** Loosen both the Passenger Side and Driver Side factory Tie Rod End Nuts using a 21mm socket (3a). Do not completely remove. Leave the Tie Rod End Nuts and hand tighten enough to prevent the Tie Rod from falling off (3b).

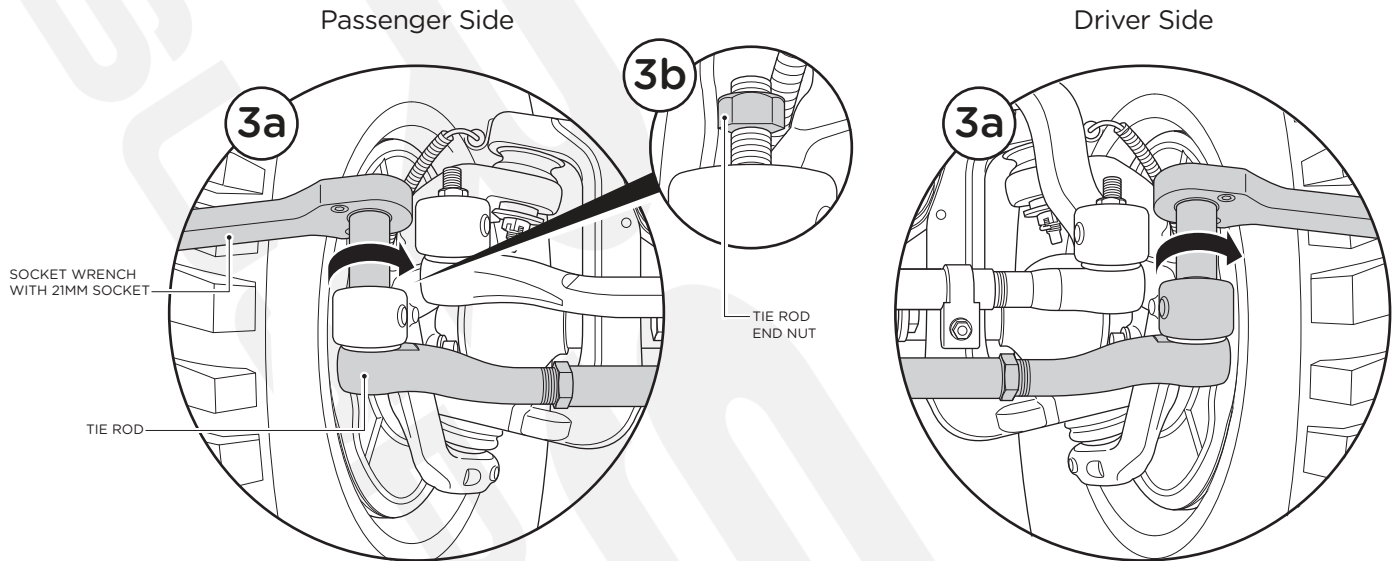

- 4.** Once the Tie Rod End Nuts are loose, gently hammer around the Knuckle until the seal breaks (4a) and the Tie Rod falls from the Knuckle (4b). Completely remove the Tie Rod by removing the Tie Rod End Nuts.

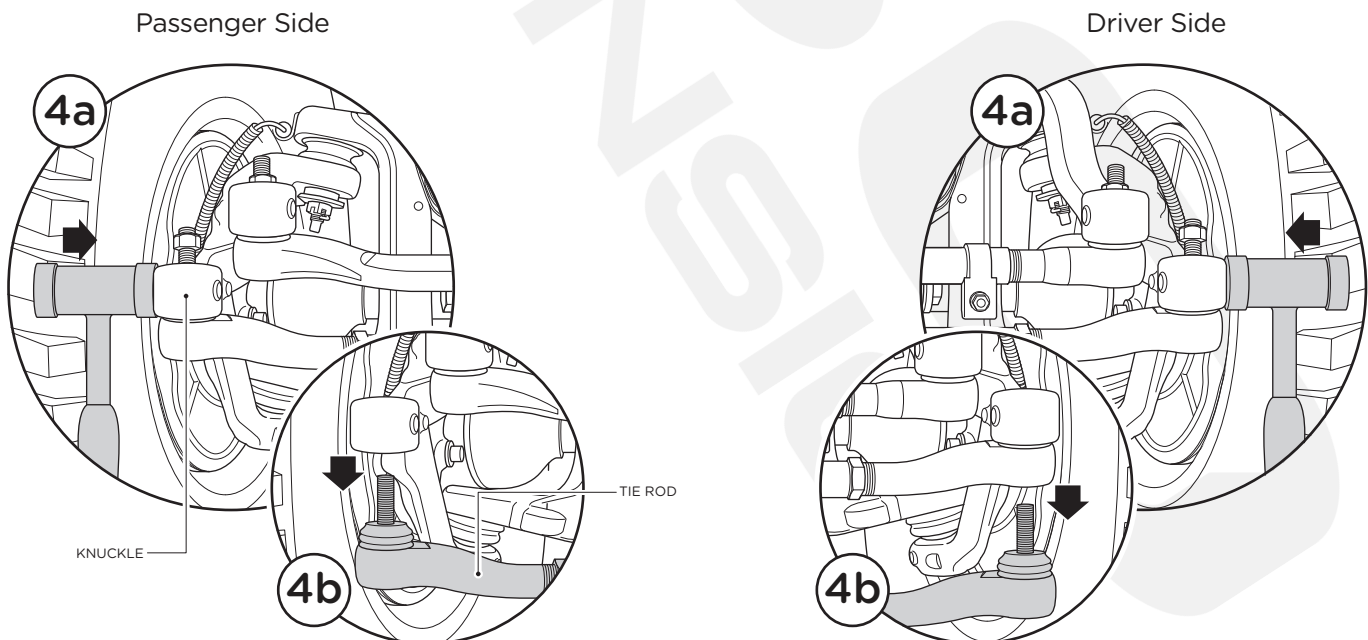

## TIE ROD INSTALLATION

170107-443900

**RSO**  
SUSPENSION

5. Measure your factory Tie Rod from the center to the end and adjust your new Tie Rod to match as close as possible. Install your new Tie Rod and torque the Tie Rod End Nuts to 63 ft lbs. If not replacing the Drag Link proceed to page 6 to reinstall your steering stabilizer and Re-install tires.

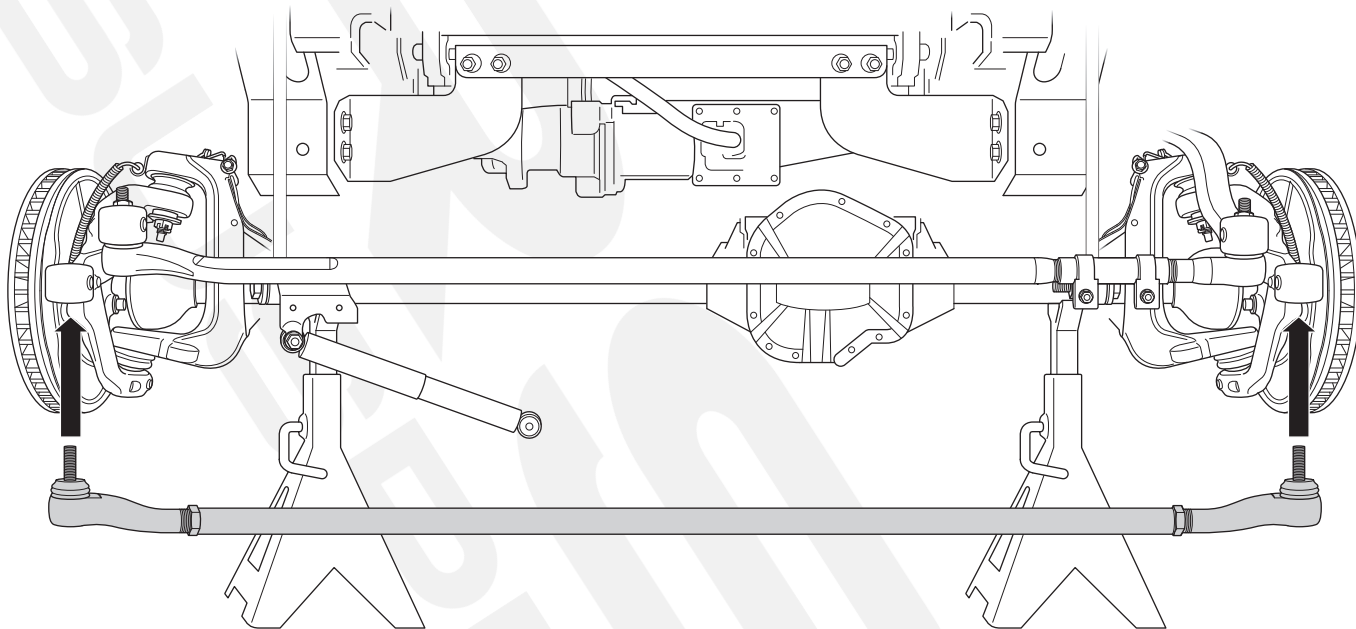

# DRAG LINK INSTALLATION

170107-444000

# RSO SUSPENSION

1. Perform steps 1 and 2 on pages 1 and 2 if not already done. Loosen both the Passenger Side and Driver Side factory Drag Link End Nuts using a 21mm socket (1a). Do not completely remove. Leave the Drag Link End Nuts on and hand tighten enough to prevent the Drag Link from falling off (1b).

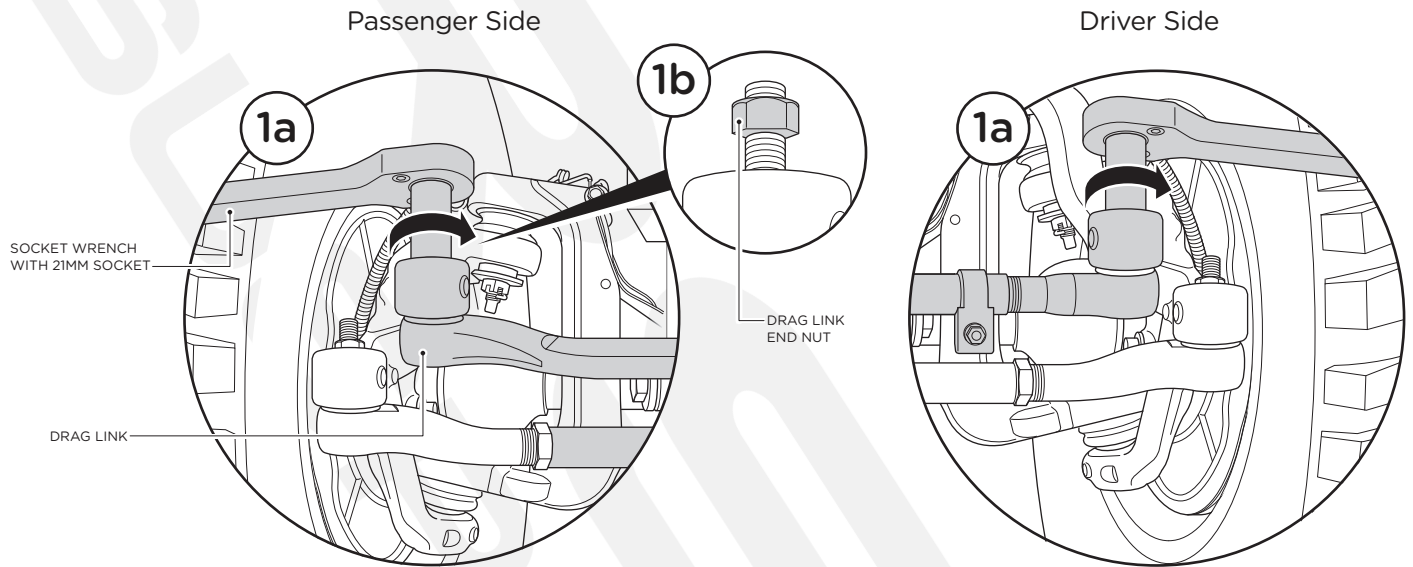

2. Once the Drag Link End Nuts are loose, gently hammer around the Knuckle until the seal breaks (2a) and the rod falls from the Knuckle (2b). Completely remove the Drag Link by removing the Drag Link End Nuts.

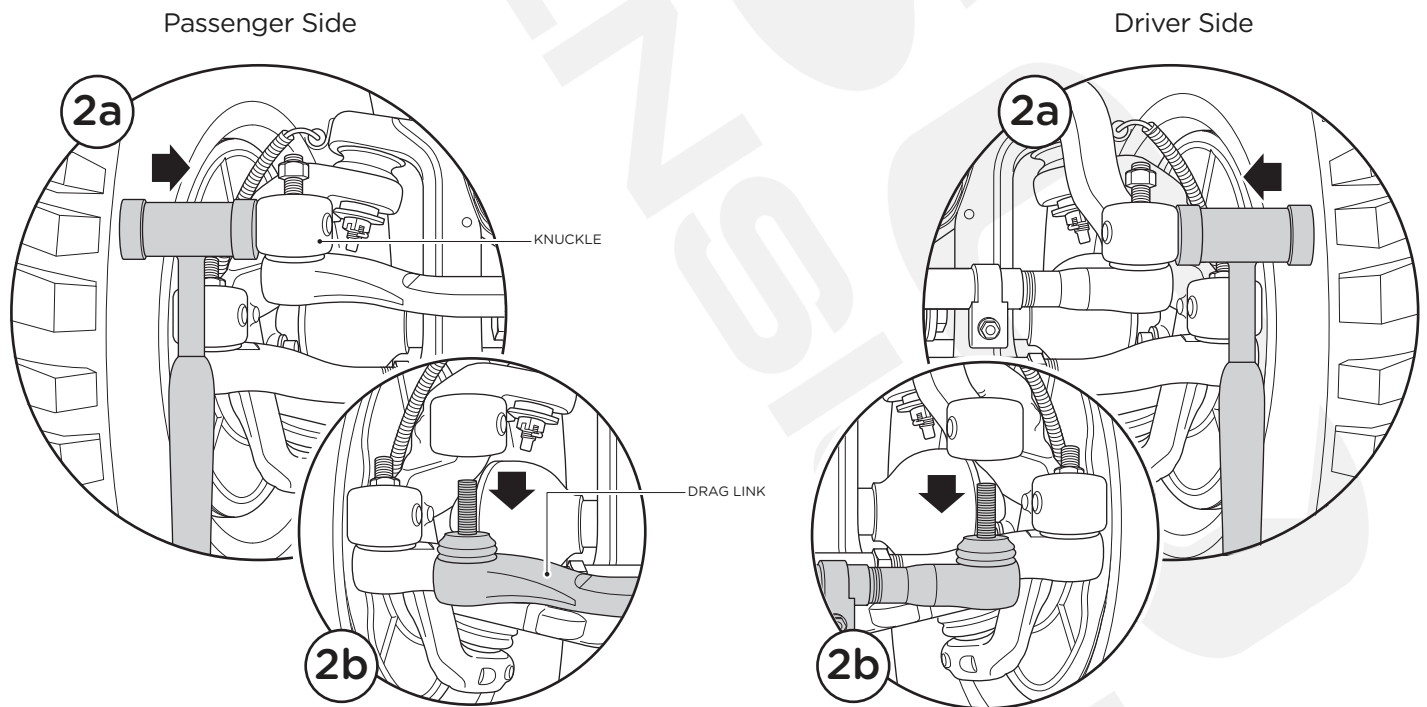

## DRAG LINK INSTALLATION

170107-444000

**RSO**  
SUSPENSION

- 3.** Install your new Drag Link and torque Drag Link End Nuts to 63 ft lbs. Re-install tires.

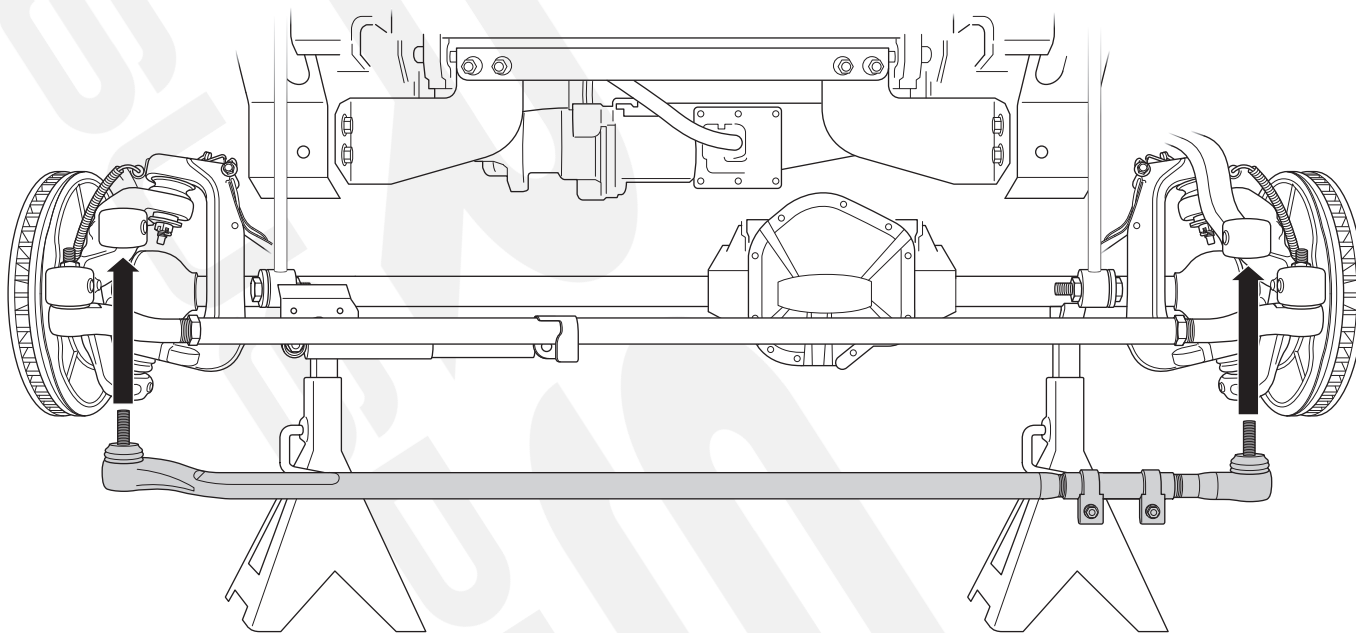



1. Reposition existing Steering stabilizer or install new Steering Stabilizer.

**Note:** If you prefer to keep the stabilizer in your factory location simply rotate the bracket so the hole is faced down.

Remove existing Bolt (1a), then install Steering Stabilizer Bolt (1b) and 7/16" Washer (1c).

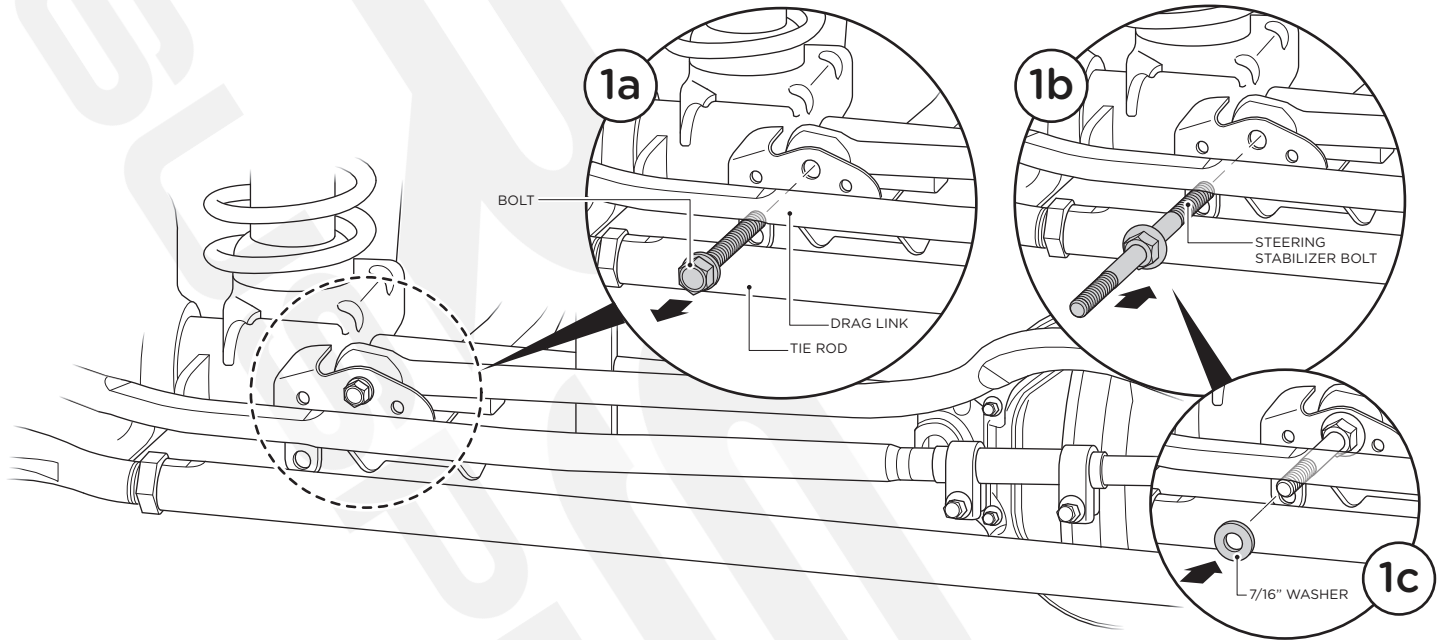

2. Install Steering Stabilizer Bracket onto the Tie Rod using 4 Socket Head Cap Screws (2a). Tighten Socket Head Cap Screws using an Allen wrench, making sure not to fully tighten at this point (2b).

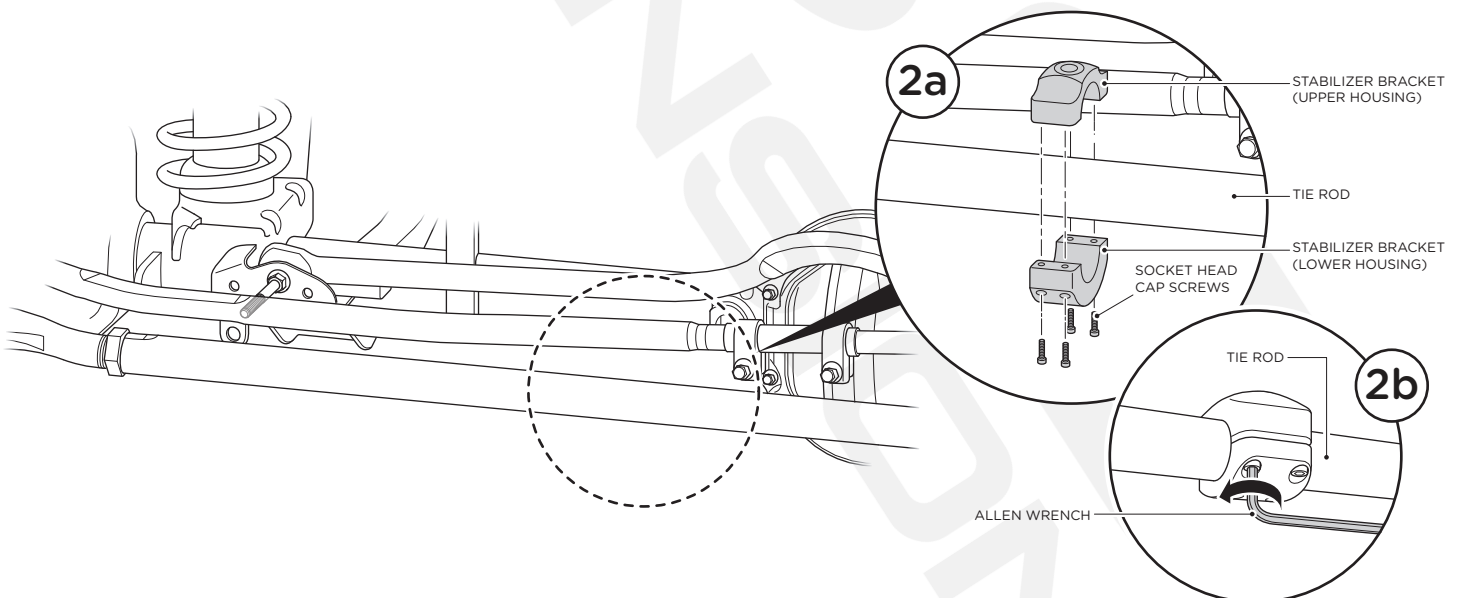

## RE-INSTALLING STEERING STABILIZER

3. Place one end of Steering Stabilizer onto the Steering Stabilizer Bolt (3a) and secure using Steering Stabilizer Nut (3b). Secure other end of Steering Stabilizer to top of Steering Stabilizer Bracket and secure using the 1/2" Hex Head Bolt and two 1/2" Washers. (3c).

Reinstall tires and wheels. Adjust your steering wheel by adjusting the collar on your new drag link until the wheels are centered while your tires are pointed straight. Then locate the screws on the Steering Stabilizer Bracket and fully tighten using an Allen Wrench (3d).

You will now want to get a professional alignment.

