

FRONT STUBBY BUMPER

SKU# FBM21JPN-RT

MAGNUM

Bumper Components:

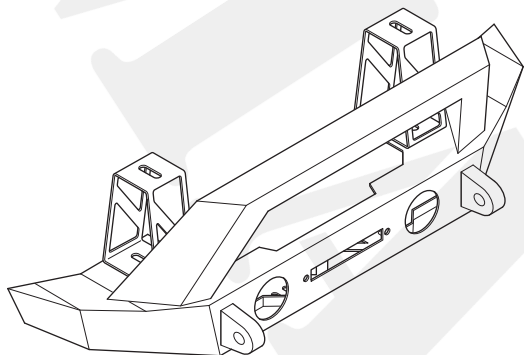

Heavy Duty Bumper
Qty 1

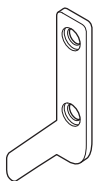

Outside Nut Plates
(1 driver/1 pass)
Qty 2

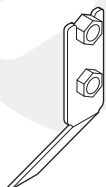

Inside Nut Plates
(1 driver/1 pass)
Qty 2

Bumper Hardware:

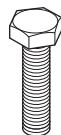

7/16"-14 x 1-1/2" Grade 8
Hex Head Bolts
Qty 80



7/16" Grade 8
Flat Washers
Qty 14



7/16" Grade 8
Lock Washers
Qty 8



7/16"-14 Grade 8
Hex Head Nuts
Qty 4

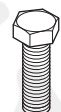

3/8"-16 x 1.25" Grade 8
Hex Head Bolts
Qty 2



3/8" Grade 8
Flat Washers
Qty 2



3/8" Grade 8
Lock Washers
Qty 2

O.E. Fog Light Hardware:



10-24 x .750"
Button Head Bolts
Qty 8



10-24
Flat Washers
Qty 8



Serrated Flanged
Nuts or Keps Nuts
Qty 8

Skid Plate Hardware:

Skid Nut Plates
(1 driver/1 pass)
Qty 2

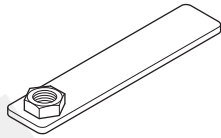

Skid Plate Hardware:



3/8-16 x .750"
Button Head
Bolts SS
Qty 4

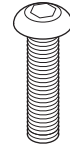

7/16-14 x 1.50"
Button Head
Bolts SS
Qty 2



3/8"
Flat Washers SS
Qty 4



7/16"
Flat Washer SS
Qty 2



3/8"
Lock Washers SS
Qty 4



7/16"
Lock Washer SS
Qty 2

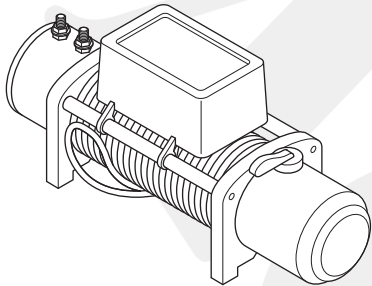

Winch Mount Hardware:

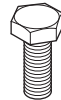

7/16-14 x 1" Grade 8
Hex Head Bolts
Qty 4



7/16" Grade 8
Flat Washers
Qty 4



7/16"
Lock Washer
Qty 4

Jack Mount Hardware:

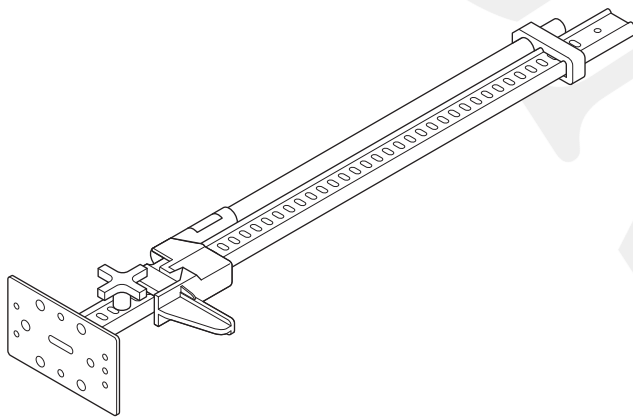

Jack Mount Hardware:

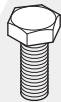

7/16-14 x 1" Grade 8
Hex Head Bolts
Qty 4



7/16"-14 Grade 8
Hex Head Nuts
Qty 4



7/16"
Flat Washers
Qty 8



7/16"
Lock Washer
Qty 4

Tools Required:

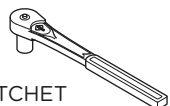

RATCHET



7/16"
SOCKET



3/8"
SOCKET

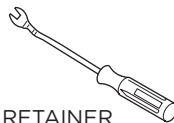

RETAINER
REMOVAL TOOL

FRONT STUBBY BUMPER

FACTORY BUMPER REMOVAL

1. Disconnect negative battery terminal.
2. Underneath the front bumper is a plastic skid plate held on with 6 push pin tabs. Using a retainer removal tool, pry up the release on each pin and remove pins with skid plate.
3. Disconnect the wiring plug from the rear of each fog light if equipped.
4. Remove the 8 nuts holding the factory bumper to the frame. There are 4 nuts per side, once removed the bumper can be pulled straight forward and removed from the vehicle.
5. Remove the Plastic Panel on top of the Front Frame Rails by removing two (2) more Push Pin Tabs.
6. Remove the Vacuum Canister (if equipped) attached to the inside Driver Frame Rail by removing two (2) Factory Bolts holding it to the frame. The hoses do not need to be removed. The Vacuum Canister can be pushed out of the way enough to install the Magnum bumper.
7. If you want to reuse the factory Fog Lights, remove them from the Factory Bumper using a Philips head screw driver. Mount the Fog Lights in the Bumper using provided hardware.

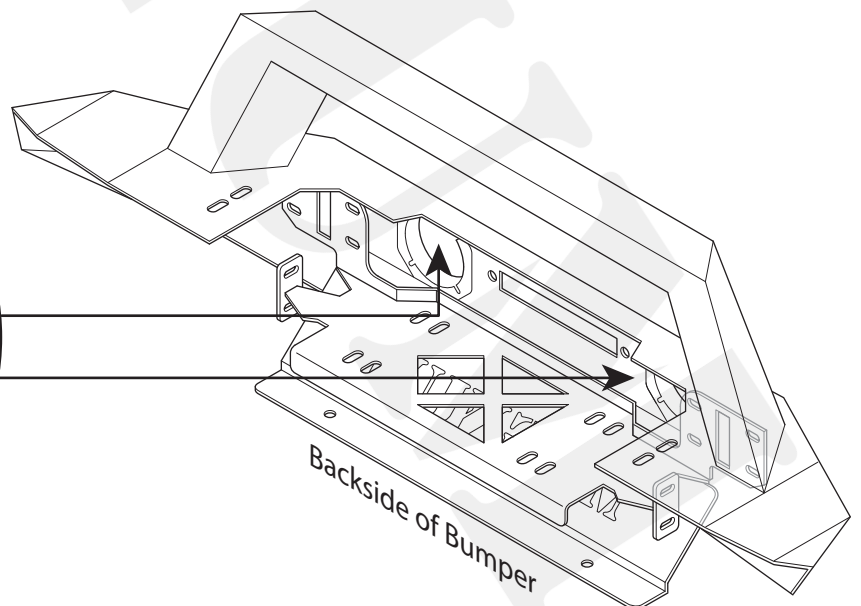
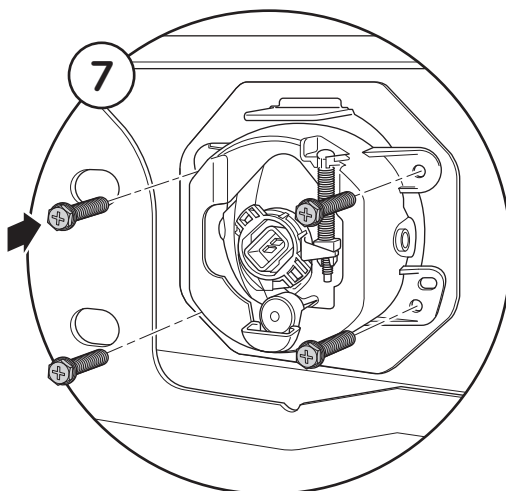
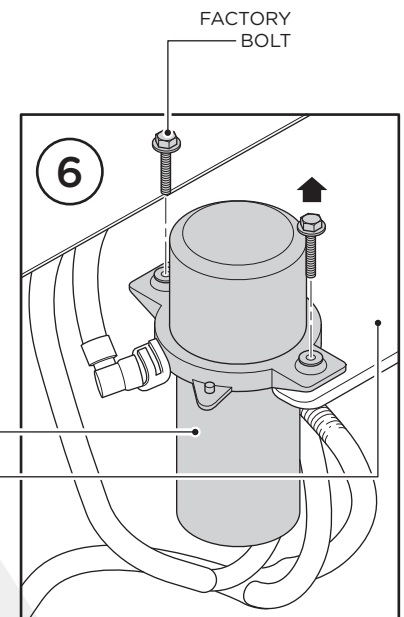
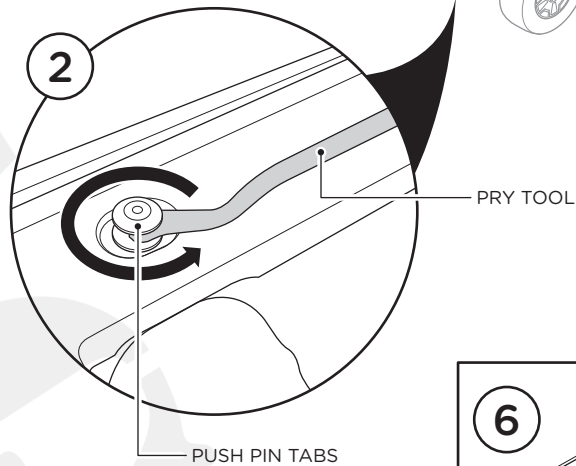
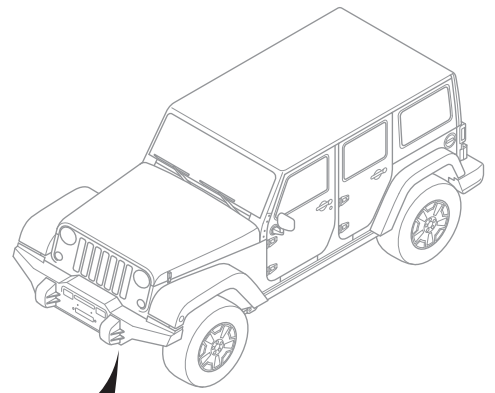

FRONT STUBBY BUMPER

BUMPER INSTALLATION

8. With help, place Bumper on front of vehicle. The Bumper must be pivoted around the Front Frame Mounts (8a). Secure each Front Frame Mount to vehicle starting with the two (2) inside holes. To complete this step, for each side you will use in total: four (4) 7/16"-14 x 1-1/2" Grade 8 Hex Head Bolts, eight (8) 7/16" Grade 8 Flat Washers, four (4) 7/16"-14 x 1-1/2" Grade 8 Lock Washers and four (4) 7/16"-14 Grade 8 Hex Head Nuts (8b). To secure to outside holes, use in total: two (2) Outside Nut Plates, four (4) Hex Head Bolts, four (4) Flat Washers, and four (4) Lock Washers (8c). *For ease of installation, bring the Nut Plates from underneath the bumper up onto the outside (front of bumper side) of the frame, lining up with the frame mount holes.

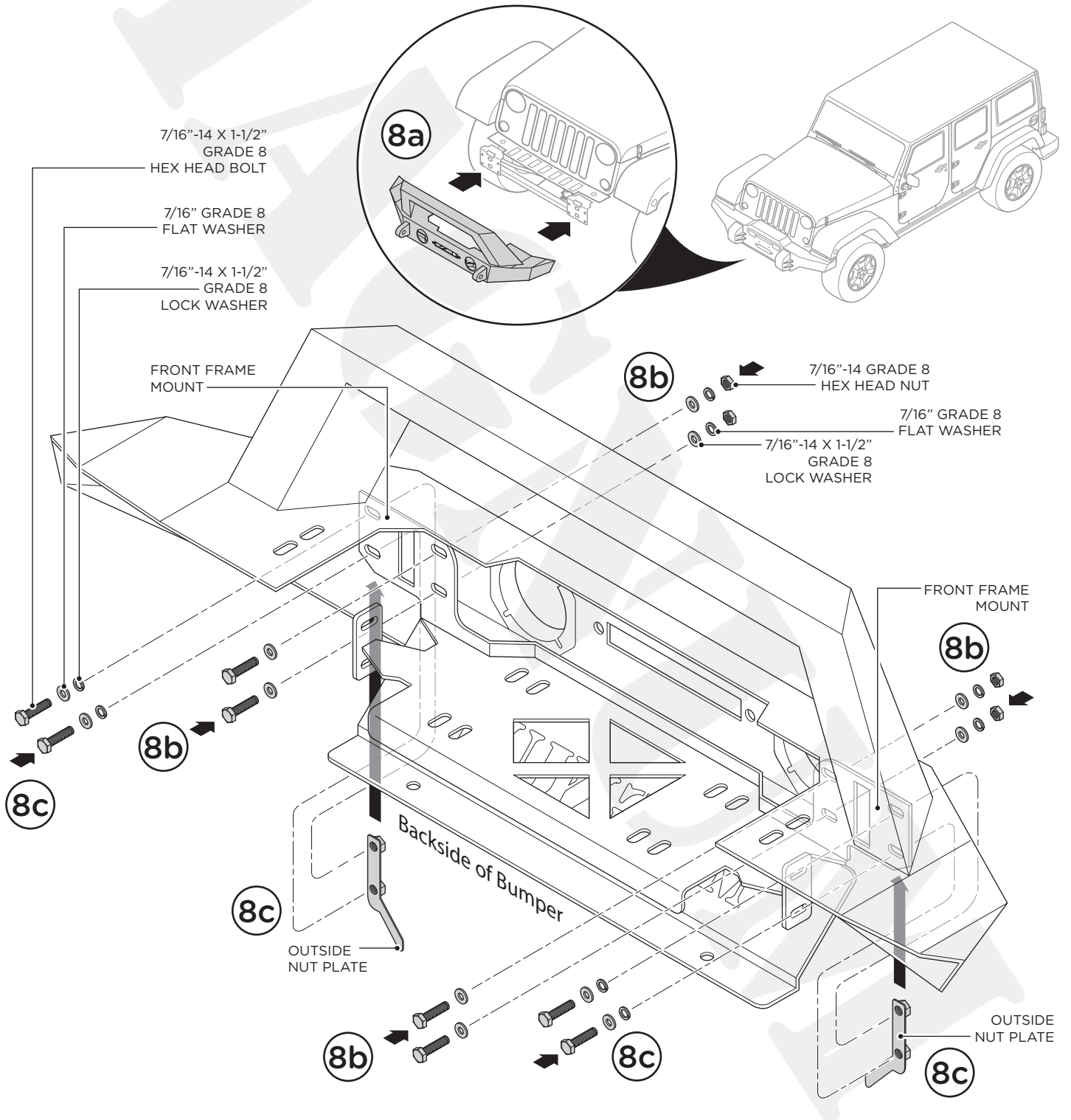

FRONT STUBBY BUMPER

BUMPER INSTALLATION

9. There are (4) nut plates to mount the bumper. The first set of nut plates are the (2) inside frame nut plates. Each nut plate must be slid up into the underside of the channel of the Jeep frame (9a). While holding the nut plate into place, secure the bracket of the bumper to the top of the inside nut plate using one (1) 7/16" Grade 8 Flat Washer, one (1) 7/16" Grade 8 Lock Washer and one (1) 7/16"-14 x 1-1/2" Grade 8 Hex Head Bolt (9b). Then, secure the bottom of the nut plate using one (1) 3/8" Grade 8 Flat Washer, one (1) 3/8" Grade 8 Lock Washer and one (1) 3/8" x 1.25" Grade 8 Hex Head Bolt (9b).

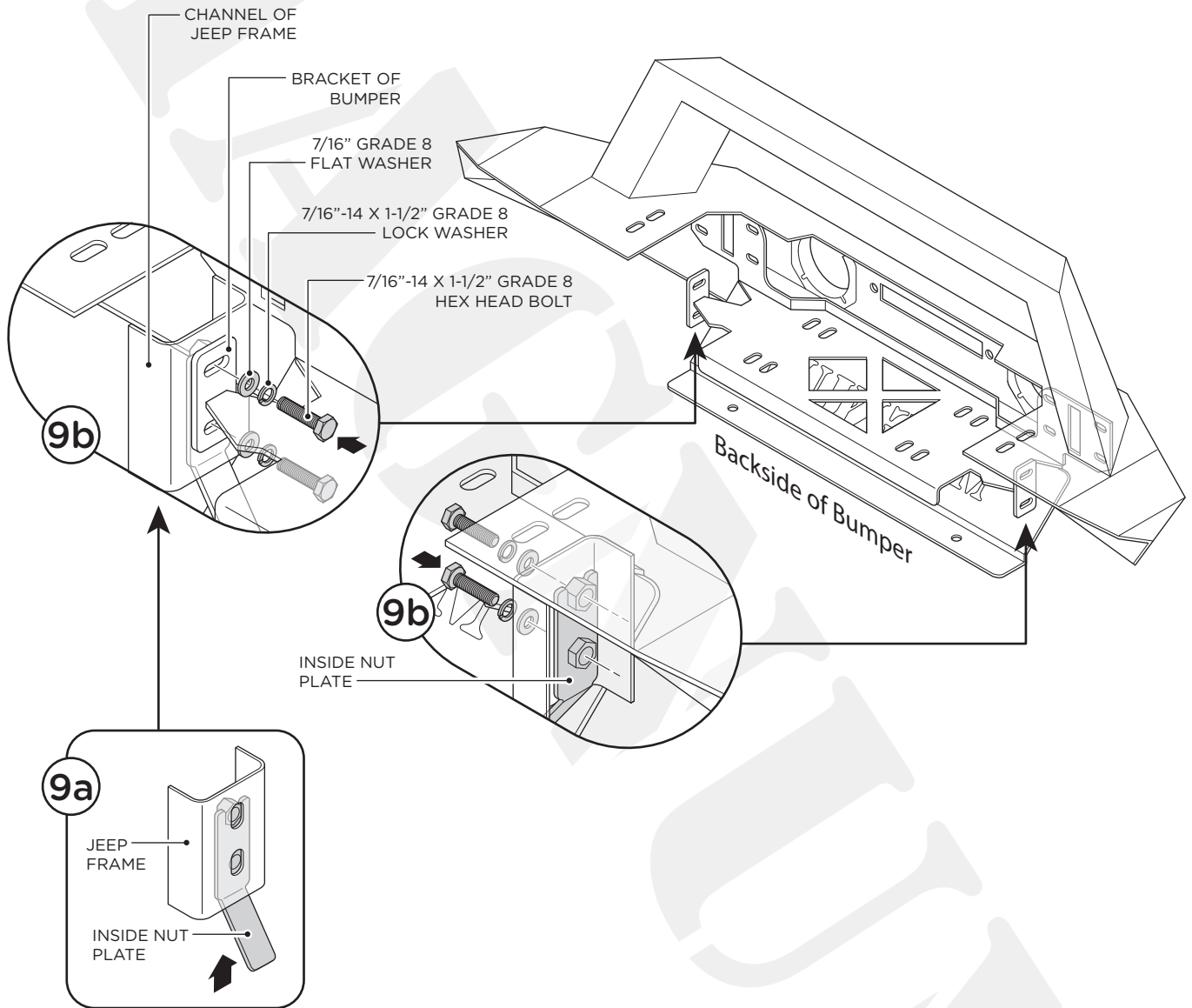

FRONT STUBBY BUMPER

BUMPER INSTALLATION

10. Reinstall Vacuum Canister with Factory Hardware.

11. If installing a Winch, proceed at this time. Depending on Winch, the Vacuum Canister may need to be relocated and its mounting bracket may need to be notched (relocation bracket is not included). A standard small chassis 8-10k Winch will fit without modifying or removing the Vacuum Canister.

12. Plug Fog Light Wiring Harness back into Fog Lights.

13. Install each Skid Plate using one (1) 7/16" Flat Washer, one (1) 7/16" Lock Washer and one (1) 7/16"-14 x 1.50" Button Head Bolt. Finish by installing four (4) 3/8"-16 x .750" Button Head Bolts SS, four (4) 3/8" Flat Washers, and four (4) 3/8" Lock Washers to the front of the skid plate for a finished look.

NOTE: 7/16" Nut Plate is placed into channel in frame of Jeep. Channel not shown in illustration for clarity.

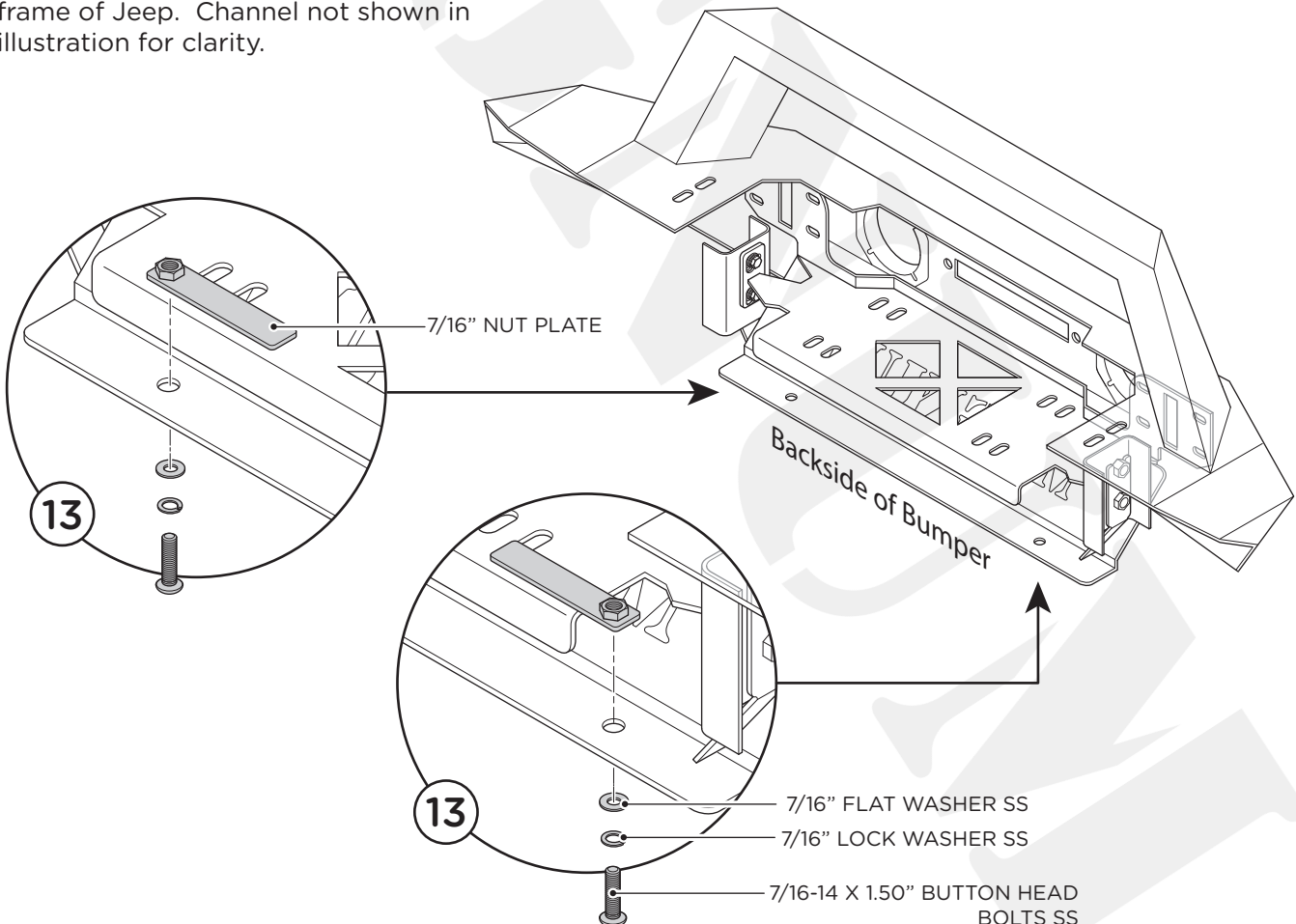
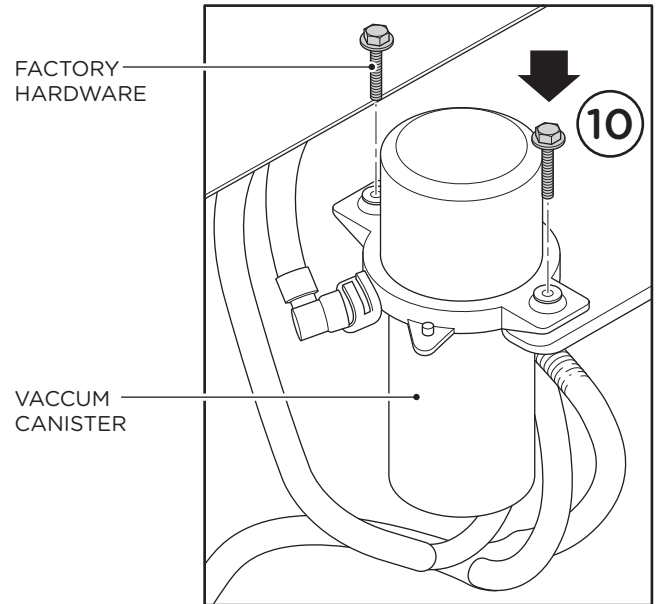

FRONT STUBBY BUMPER

BUMPER INSTALLATION

14. The Bumper includes mounts for a Hi-Lift type Jack (no jack or lights are included with the bumper). These mounts bolt to the holes in the top of the Bumper and sets the Jack above the Winch.

Install each Mount for Hi-Lift Jack to bumper using two (2) 7/16"-14 x 1-1/2" Grade 8 Hex Head Bolts, two (2) 7/16" Grade 8 Flat Washers, two (2) 7/16"-14 x 1-1/2" Grade 8 Lock Washers and two (2) 7/16"-14 Grade 8 Hex Head Nuts.

It may be necessary to remove Hi-Lift Base from jack.

15. Install Hi-Lift jack using two (2) 7/16" Grade 8 Flat Washers, two (2) 7/16"-14 x 1-1/2" Grade 8 Lock Washers and two (2) 7/16"-14 x 1-1/2" Grade 8 Hex Head Bolts and two (2) 7/16" Grade 8 Hex Head Nuts (1b).

17. Reconnect battery ground.

