

Bumper Components:

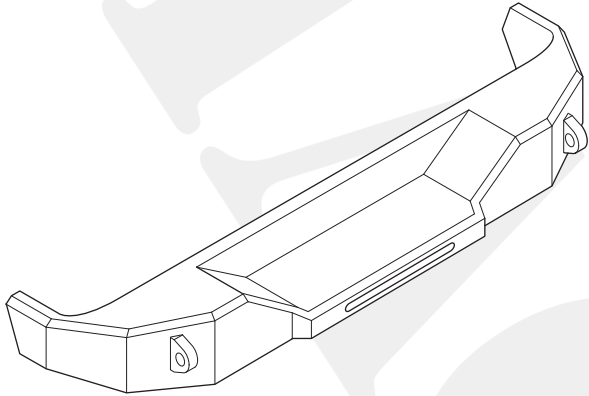

Heavy Duty Bumper
Qty 1

Bumper Hardware:



1/2"-13" Grade 8
Hex Head Nuts
Qty 6



1/2" Grade 8
Lock Washers
Qty 6



1/2" Grade 8
Flat Washers
Qty 6



Plastic Push Nuts
Qty 4

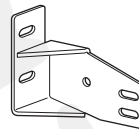

Mounting Bracket
Qty 2

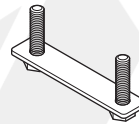

Double T-Bolt
Qty 2

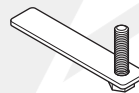

Single T-Bolt
Qty 2

Third Brake Light/Running Light Components:

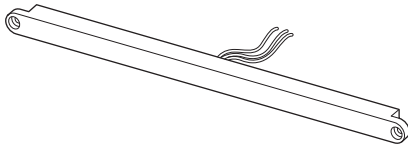

LED Brake Light/Running Light
Qty 1

Third Brake Light/Running Light Hardware:



M3-.50 Serrated
Flanged Nut
Qty 2



M3-.50 x 20MM
Allen Head Bolt
Qty 2

Tools Required:

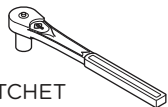

RATCHET



1/2"
SOCKET



M3
SOCKET

OE BUMPER REMOVAL

1. Disconnect negative battery terminal.
2. Remove spare tire.
3. Remove (2) outside frame bolts holding the rear bumper brackets to the vehicle. There are (2) per side. Set aside to re-use for Magnum bumper installation.
4. Remove (2) bolts holding the stock bumper to the rear cross member. Access the bolts from underneath the rear of the vehicle in between the frame rails.
5. Remove remaining (2) bolts holding rear bumper to rear cross member brackets.
6. Pull straight back on rear bumper to remove from vehicle.
7. Remove factory tow hook from driver side frame rail.

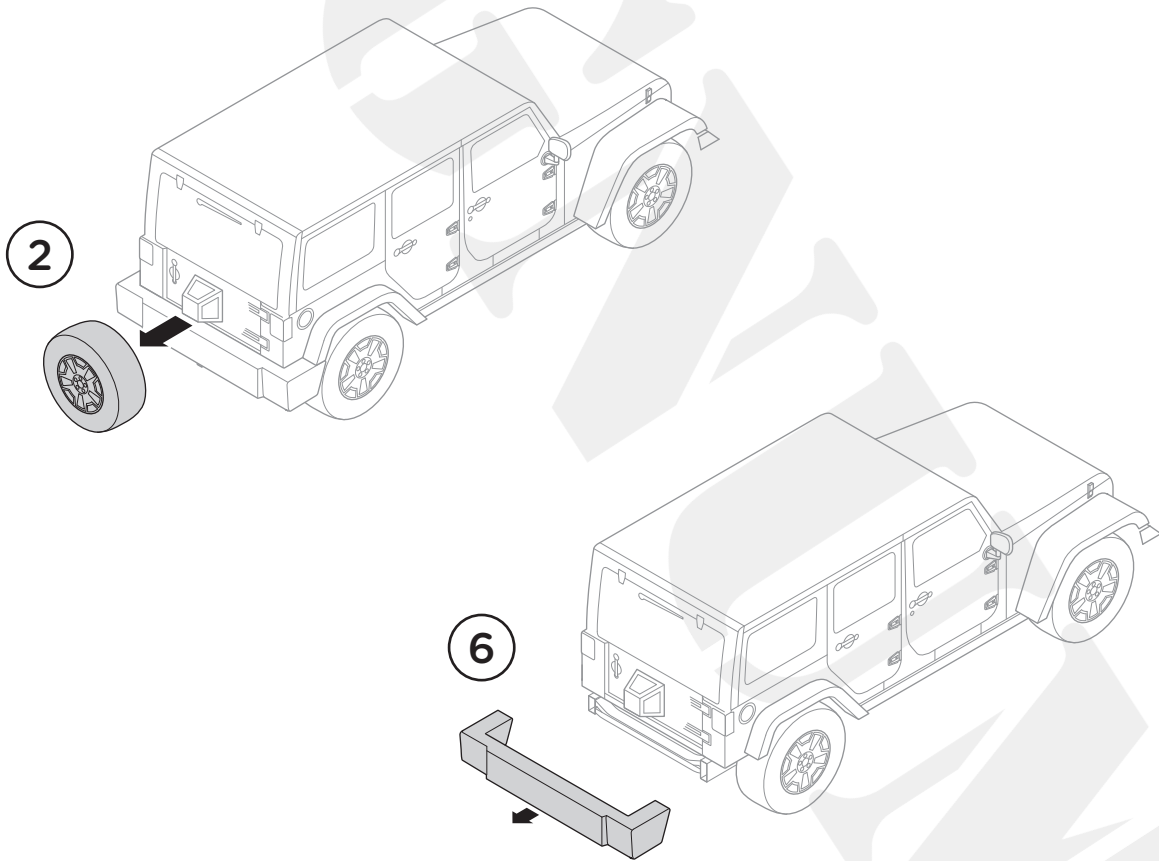

BUMPER INSTALLATION

8. Install Magnum Bumper Outside Frame Brackets using two (2) outside Factory Frame Bolts (8a) and provided T-Bolts (8b). Do not fully tighten yet.

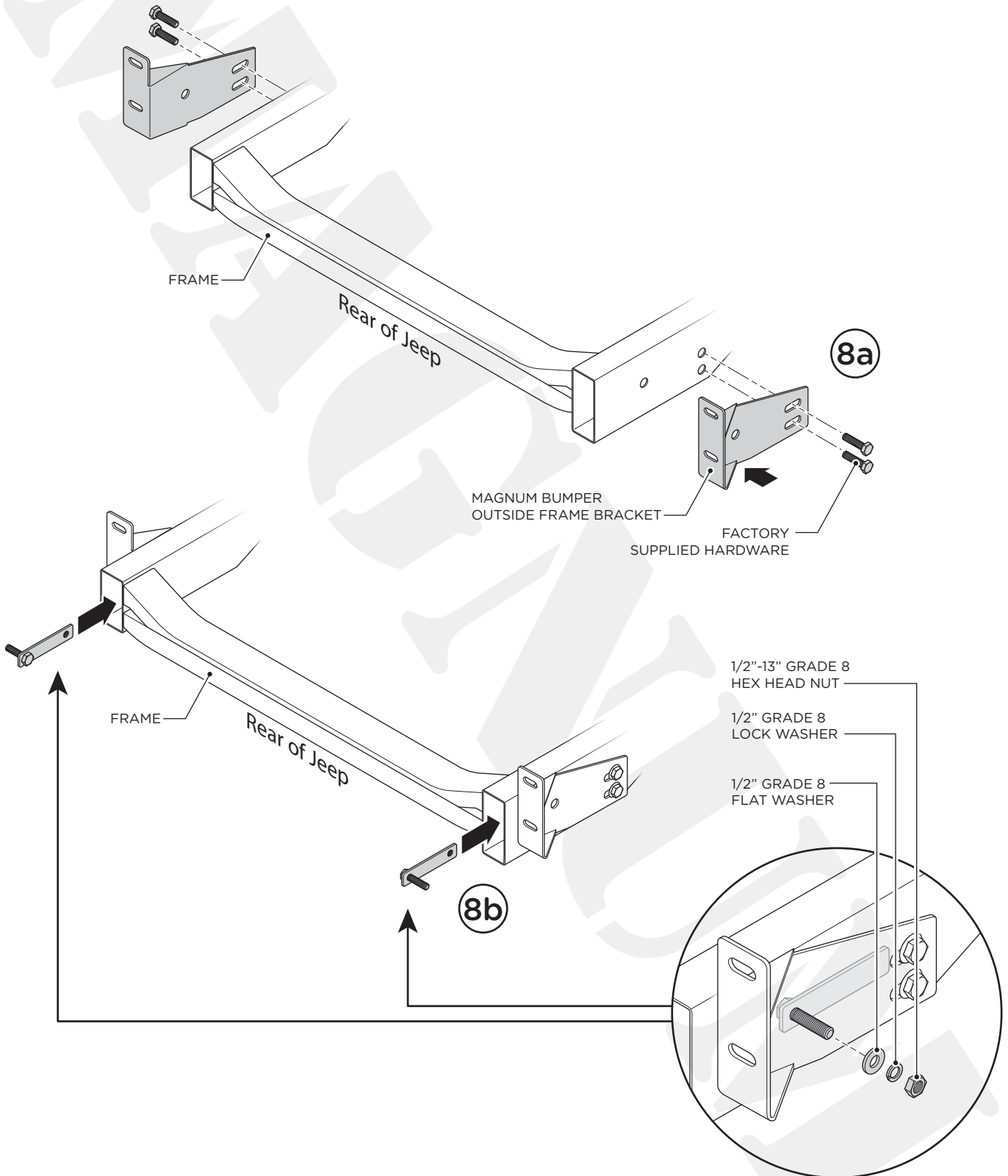

9. Install provided Double T-Bolts into Magnum Bumper using two (2) provided Plastic Push Nuts per T-Bolt.

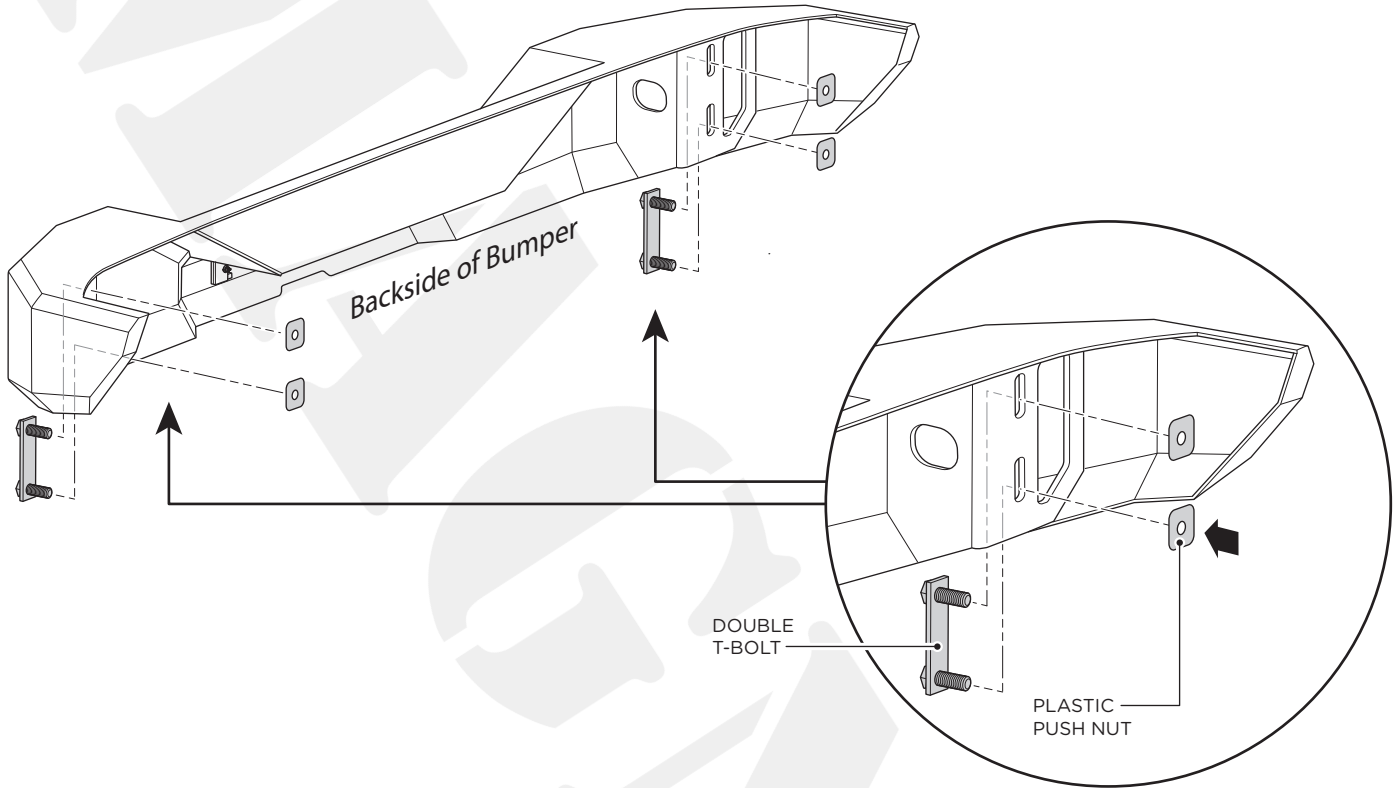

10. With help, line up Double T-Bolts with Outside Brackets on vehicle. Secure Bumper to each Outside Bracket using one (1) 1/2" Grade 8 Flat Washer, one (1) 1/2" Grade 8 Lock Washer and one (1) 1/2"-13" Grade 8 Hex Head Nuts per Bracket. Do not fully tighten.

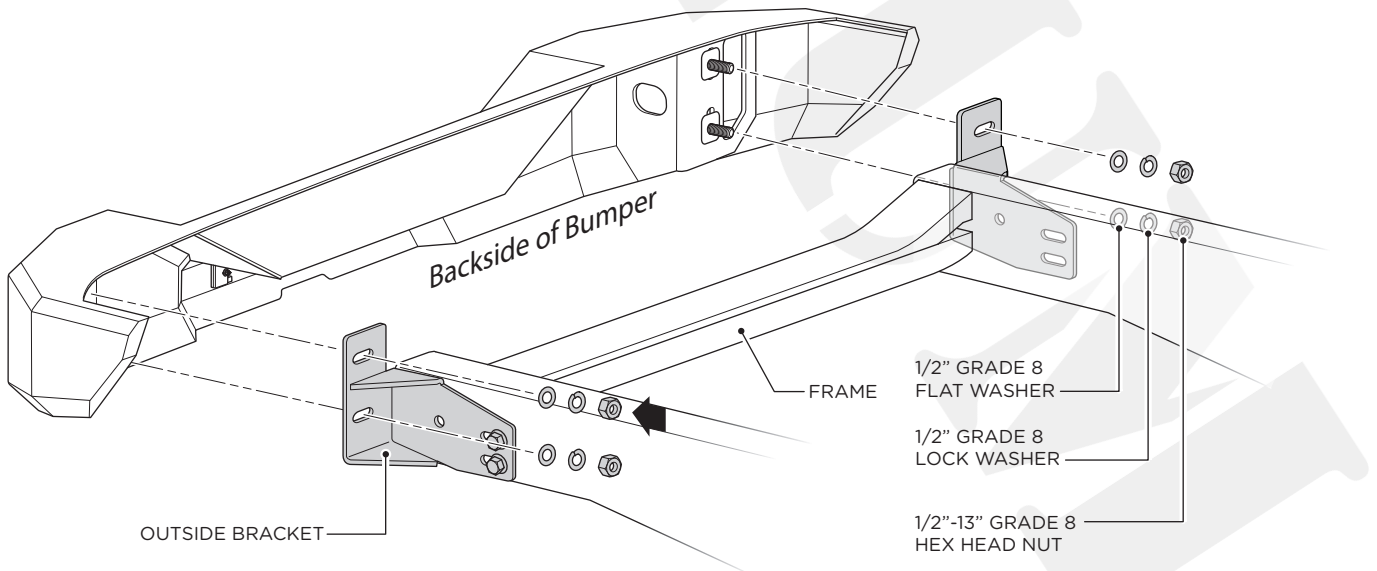

1. Install LED Light into Rear Bumper using two (2) M3-.50 x 20MM Allen Head Bolts and two (2) M3-.50 Serrated Flanged Nuts.

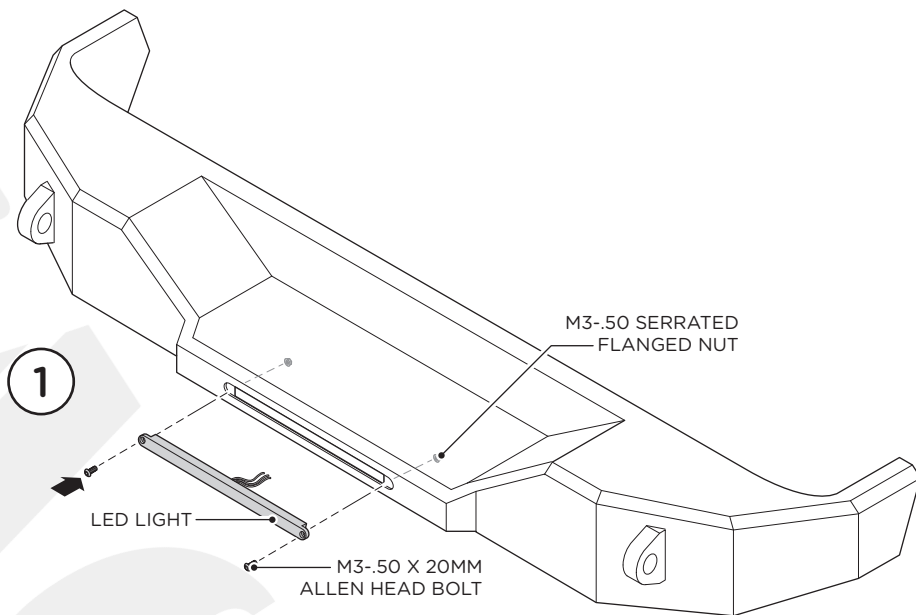

2. Remove Rear Passenger Side Tail Light by unscrewing two (2) Screws closest to the Spare Tires.

3. Using a test light, determine which wire is for the Running Lights and mark it.

4. Open Tail Gate and remove Plastic Panels on back side of Tail Gate by gently pulling until the Clips release.

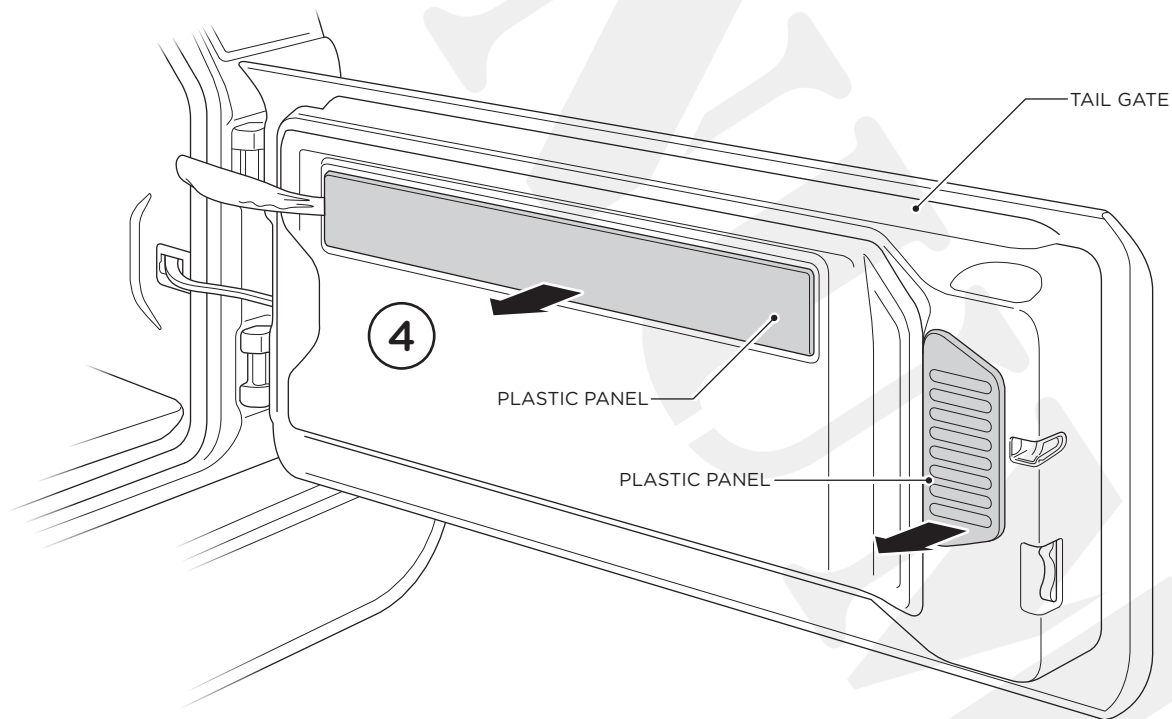

5. Remove the Plastic Trim Panel in Passenger Side Rear Corner of vehicle by gently pulling on the top corner until the clip releases.

6. Using a test light, locate the wires for the Factory Third Brake Light and determine which is positive and negative, mark them accordingly behind the panel inside the Rear Passenger Side Corner.

Once marked, replace the two (2) Plastic Panels on the back of the Tail Gate.

7. Once all three (3) Wires have been located and marked, disconnect Negative Battery Terminal.

8. You will need to route and extend the Wires on the LED Third Brake Light to reach the Factory Wiring. The **WHITE** and **RED** Wires go from the LED Third Brake Light to the Panel in the Rear Passenger Side where the Wires for the Factory Third Brake Light were located.

These Wires can be routed between the Bumper and Body and underneath the Weather Stripping. Be careful it does not get pinched by the Tail Gate. Quick splice the **WHITE** wire to the negative from the Factory Third Brake Light and the **RED** wire to the positive from the Factory Third Brake Light.

The **BLACK** wire goes to the Driver Side Rear Tail Light. Quick splice it to the Wire for the Running Lights.

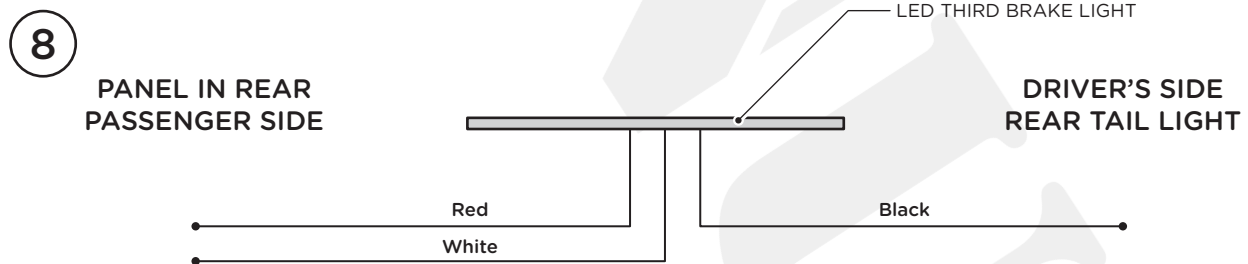
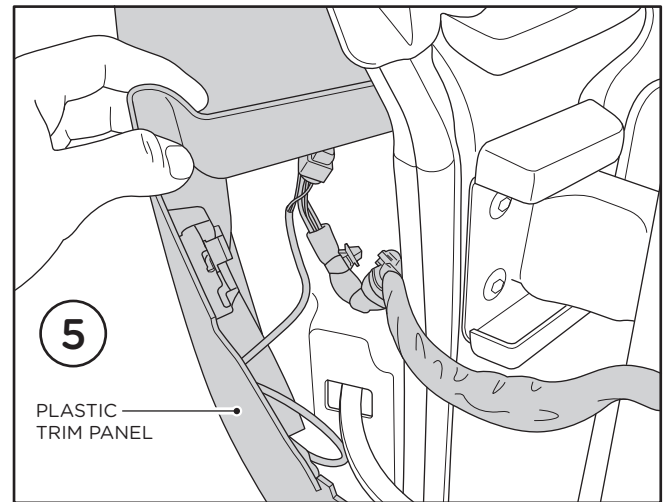

9. Once all Wires are connected, snap Trim Panel back into place and reinstall Tail Light. Be careful no Wires are going to get pinched by the Tail Gate Hinge, Panel, Tail Light or anything else.

10. Reconnect Negative Battery Terminal and test the LED Third Brake Light. The Light should come on with the Headlights and it should shine brighter when the Brakes are applied.