

SKU# RBM45JPN

HEAVY DUTY REAR BUMPER

MAGNUM

Bumper Components:

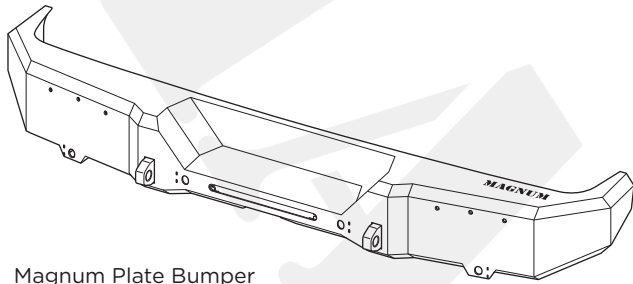

Magnum Plate Bumper
Qty 1

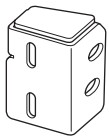

Outside Bracket
Qty 2

Bumper Hardware:

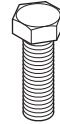

M10 1.50 x 35MM
Hex Head Bolts
Qty 4



M6-1.00 x 12mm
Hex Head Bolts
Qty 4



M10 1.50
Hex Head Nuts
Qty 4



M6-1.00
Hex Head Nuts
Qty 4



M10 Lock Washers
Qty 4



M6 Flat Washers
Qty 8

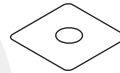

M10 Plastic
Push Nuts
Qty 4



M6 Lock Washers
Qty 4



M10 Flat Washers
Qty 8

Third Brake Light/Running Light Components & Hardware:

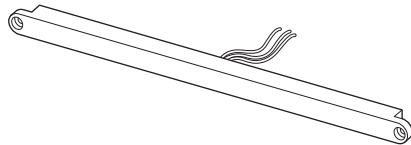

Third Brake Light/Running Light
Qty 1



M3-.50 Serrated
Flanged Nut
Qty 2



M3-.50 x 20MM
Allen Head Bolt
Qty 2

License Plate Light Components:

License Plate LED Light
Qty 1

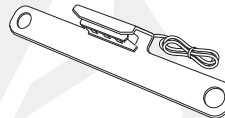

Wire Connectors
Qty 2

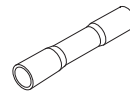

Sensor Hole Plug Components:

Sensor Plugs
Qty 4



Note: These are preinstalled on bumper. If you're installing bumper with parking sensors you must use OE sensors and bezels.

Tools Required:

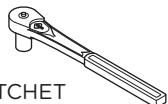

RATCHET



M10
SOCKET



M6
SOCKET



M3
SOCKET

Installation

1. Open the Hood and disconnect the Negative Battery Terminal.
2. Begin by unplugging the Rear Bumper Wiring Harness (for License Plate Light and Sensors.)
3. Remove Spare Tire.
4. Remove two (2) Bolts holding the Rear Bumper to the frame of the vehicle. There are two (2) per side. Set aside this hardware for installation of Magnum Bumper. The Factory Tow Hook should be held on by one (1) extra Bolt on the Driver Side in the bottom of the Frame Rail. You must remove this to complete the removal of the Tow Hook.
5. Remove three (3) Bolts holding the Plastic Wheel Well Cover to gain access to the Side Support Brackets. Once these are removed, continue by removing the Side Support Brackets. These are held on by three (3) Bolts, one (1) to the Frame and two (2) to the Bumper assembly. Repeat this step for opposite side. Remove two (2) Bolts attaching Bumper Assembly to Receiver. These are located on the bottom of the crossmember located between the Frame Rails.
6. Pull straight back on rear bumper to remove from vehicle.

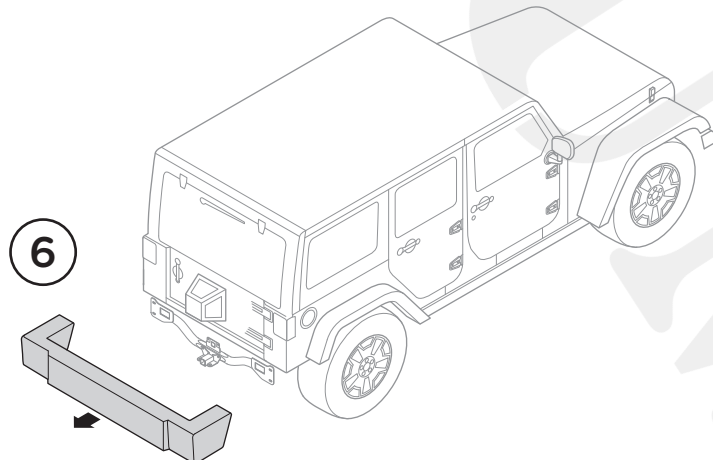
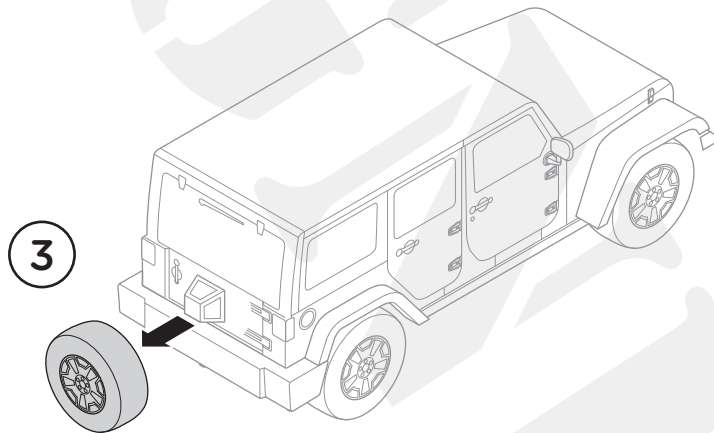

7. Install Outside Brackets to the Frame using the factory hardware removed previously in step 2. Do not fully tighten yet

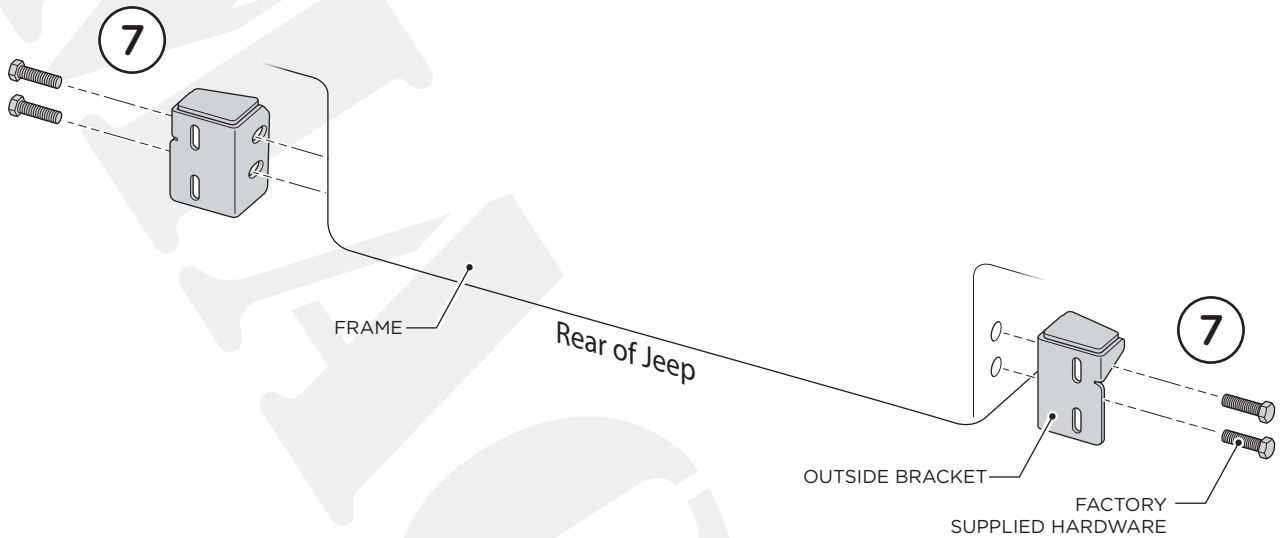

8. Install provided four (4) M10 Bolts and four (4) M10 Flat Washers into Magnum Bumper using the provided four (4) M10 Plastic Push Nuts.

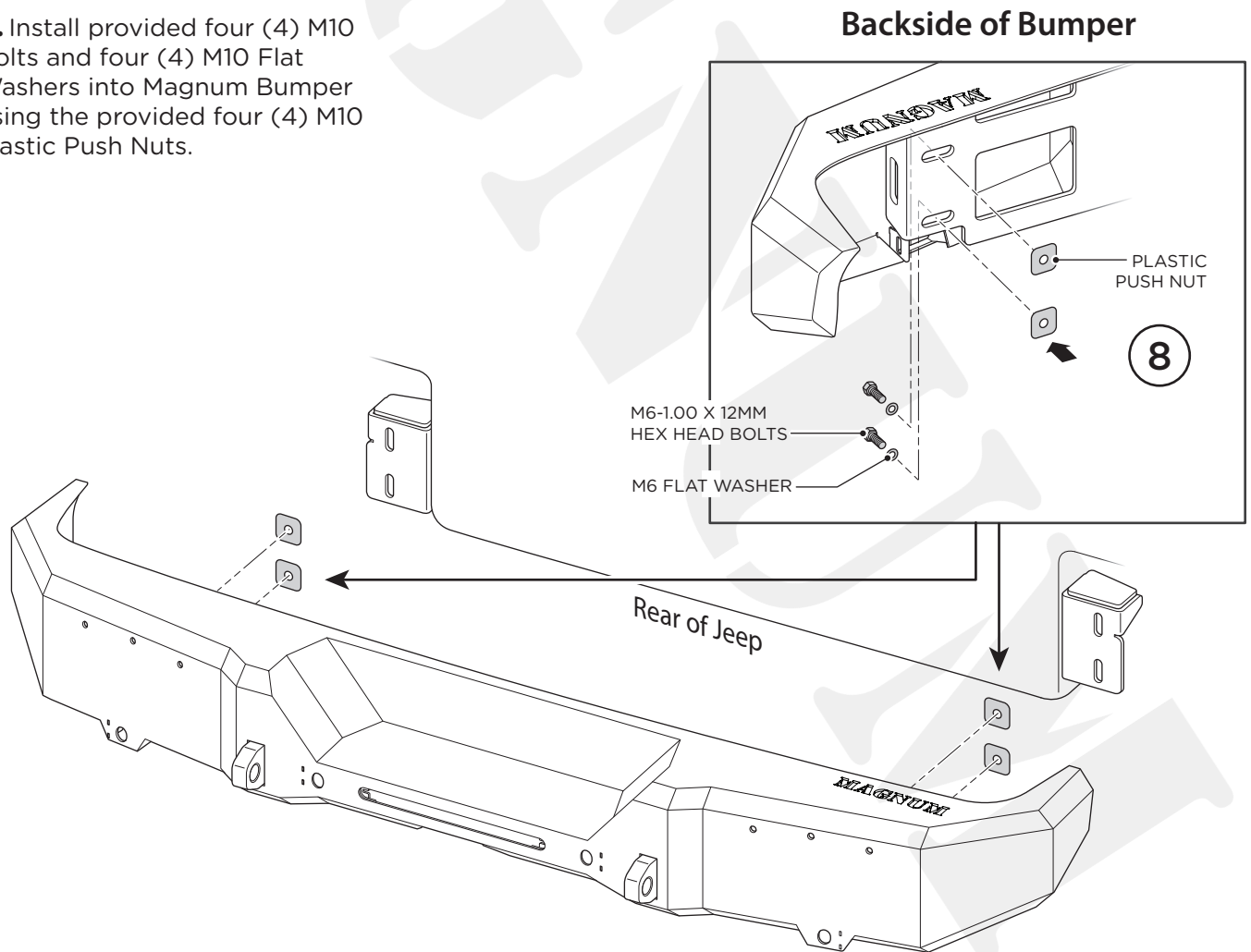

9. With help, attach Bumper to the Outside Brackets and loosely tighten using two (2) M10 Flat Washers, two (2) M10 Lock Washers and two (2) M10 1.50 Hex Head Nuts per Bracket.

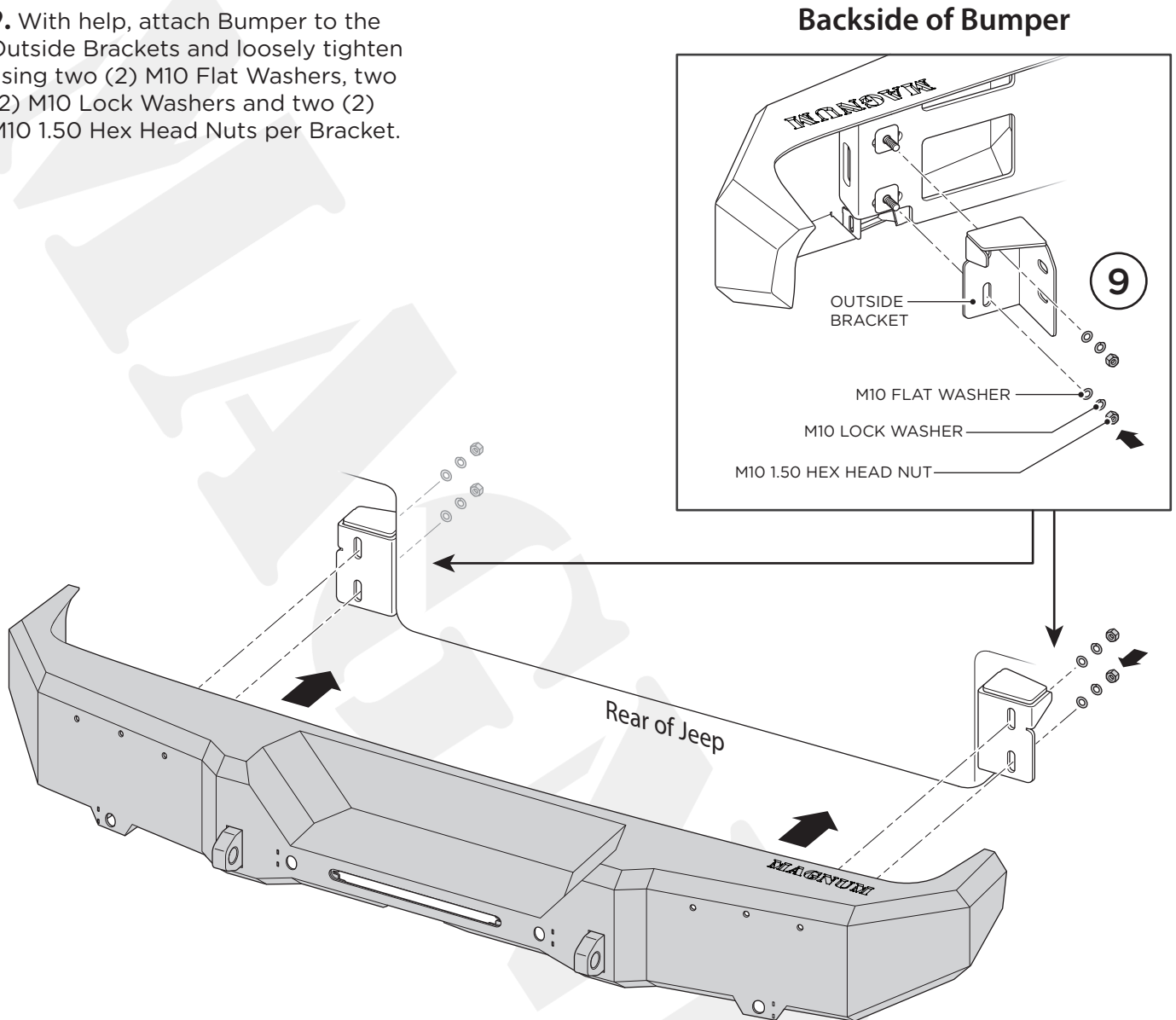

10. With the Magnum Bumper now attached, align and tighten all hardware from Outside Brackets to the Frame, followed by Bumper to Outside Brackets. Leave an 1/8" - 3/16" gap between the Bumper and the Body of the vehicle to prevent contact in the future.

11. Re-install Spare Tire and (if equipped) remove all Sensors with Harness from Factory Bumper and install into Magnum Bumper at this time.

12. Plug in Factory Wiring Harness to Sensor Harness and ensure Sensors are working properly (Sensors may need to be adjusted up and down to eliminate any warnings. The Bracket that OW Sensors are installed into allow +/- 10 degrees of adjustment up/down. Once you have the Sensors angled as needed, tighten all provided M6 hardware and check for any faults. Tabs can also be pried open slightly to relieve tension on sides of OE Sensors which can sometimes trigger warnings.)

Third Brake Light Installation Instructions

1. Install LED Light into Rear Bumper using two (2) M3-.50 x 20MM Allen Head Bolts and two (2) M3-.50 Serrated Flanged Nuts.

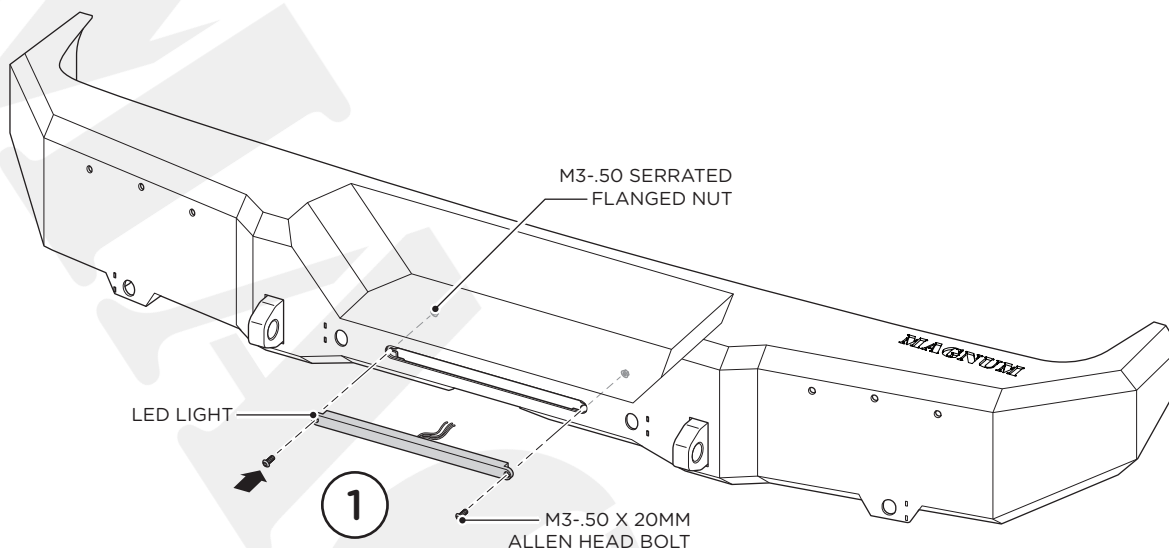

2. Remove Rear Passenger Side Tail Light by unscrewing two (2) Screws closest to the Spare Tires.
3. Using a test light, determine which wire is for the Running Lights and mark it.
4. Open Tail Gate and remove Plastic Panels on back side of Tail Gate by gently pulling until the Clips release.

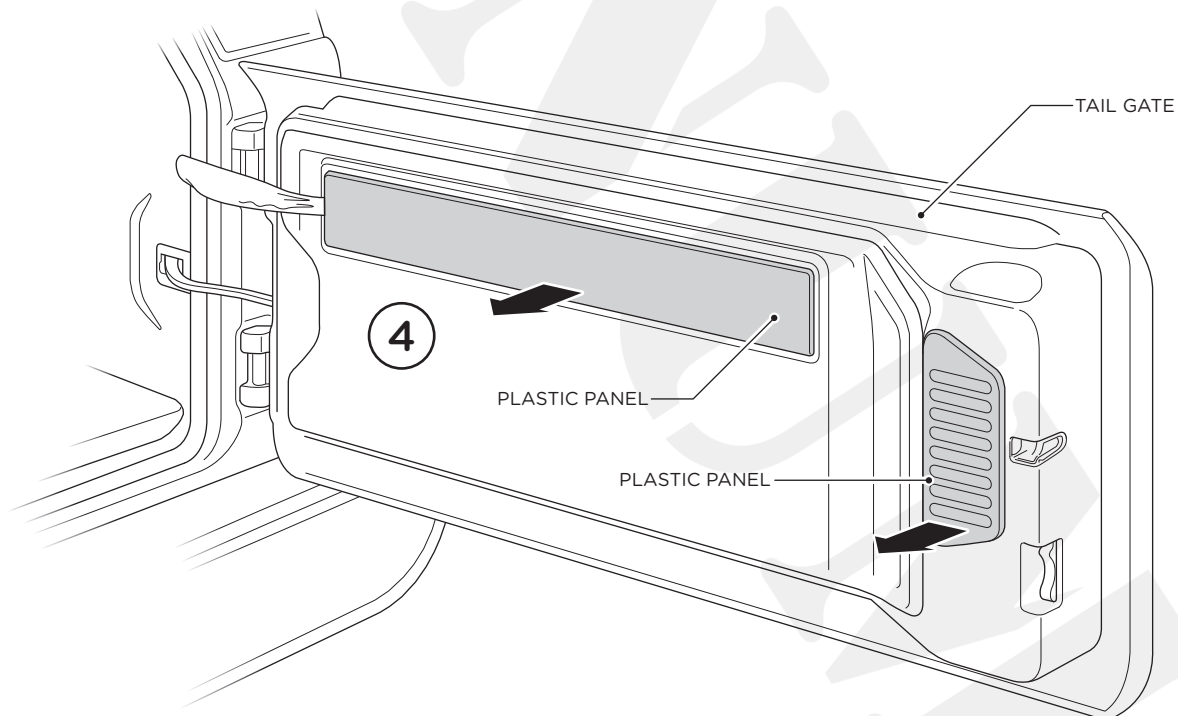

5. Remove the Plastic Trim Panel in Passenger Side Rear Corner of vehicle by gently pulling on the top corner until the clip releases.

6. Using a test light, locate the wires for the Factory Third Brake Light and determine which is positive and negative, mark them accordingly behind the panel inside the Rear Passenger Side Corner.

Once marked, replace the two (2) Plastic Panels on the back of the Tail Gate.

7. Once all three (3) Wires have been located and marked, disconnect Negative Battery Terminal.

8. You will need to route and extend the Wires on the LED Third Brake Light to reach the Factory Wiring. The **WHITE** and **RED** Wires go from the LED Third Brake Light to the Panel in the Rear Passenger Side where the Wires for the Factory Third Brake Light were located.

These Wires can be routed between the Bumper and Body and underneath the Weather Stripping. Be careful it does not get pinched by the Tail Gate. Quick splice the **WHITE** wire to the negative from the Factory Third Brake Light and the **RED** wire to the positive from the Factory Third Brake Light.

The **BLACK** wire goes to the Driver Side Rear Tail Light. Quick splice it to the Wire for the Running Lights.

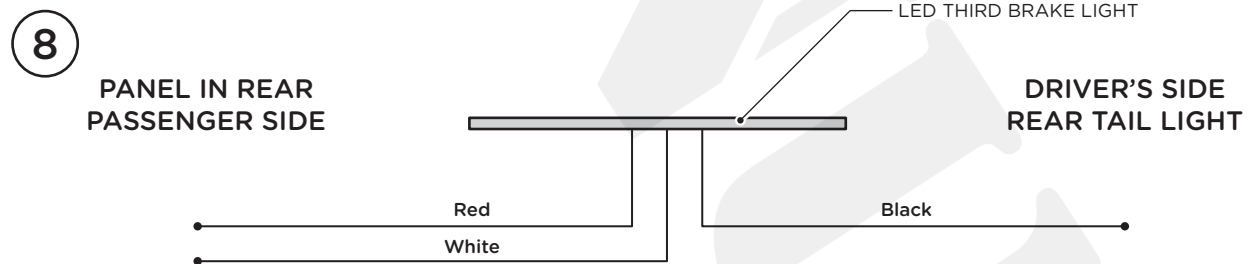
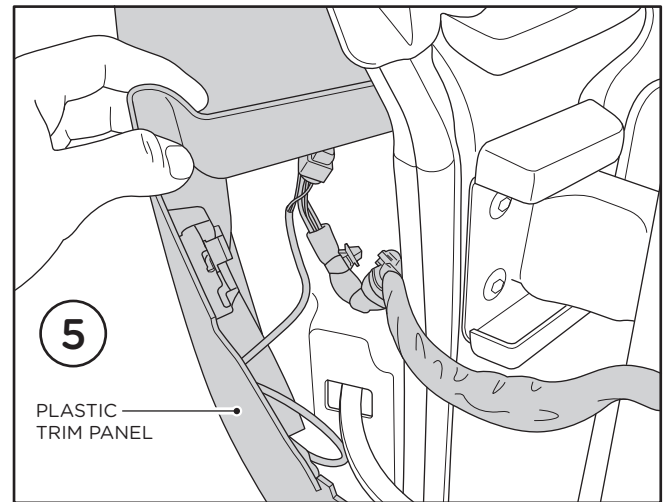

9. Once all Wires are connected, snap Trim Panel back into place and reinstall Tail Light. Be careful no Wires are going to get pinched by the Tail Gate Hinge, Panel, Tail Light or anything else.

10. Reconnect Negative Battery Terminal and test the LED Third Brake Light. The Light should come on with the Headlights and it should shine brighter when the Brakes are applied.

LED License Plate Light Installation Instructions

- 1. IMPORTANT:** Remove the ground wire from battery before making any electrical connections!
- 2.** Remove the two factory screws holding the top of the license plate to the bumper.
- 3.** Locate the factory license plate light and cut the wires. Next, determine which wire is positive and which wire is negative using a vehicle wiring diagram or a voltmeter.
- 4.** Look closely at the LED License Plate Light provided in your kit to determine which wire is negative. Once you have determined positive and negative on both your LED License Plate Light and your vehicle wiring, securely route wires and connect the two corresponding leads together. Leads may need to be extended using additional wires and connectors. If leads are not connected properly, your LED License Plate Light will not turn on.
- 5.** Once the wiring is routed and connected slide your LED License Plate Light behind your license plate and reinstall the factory screws through the top license plate holes. Tighten the license plate so it's secure but use caution to not overtighten if the wiring is routed between the license plate and the bumper so you do not cut into the wiring.
- 6.** Reconnect your ground wire to the battery and test your new LED License Plate Light. The installation is now complete!